



# OLYMPIA ATLAS

HOUT – BOIS – WOOD

NL - Installatiehandleiding

FR - Notice d'installation

EN - Installation manual

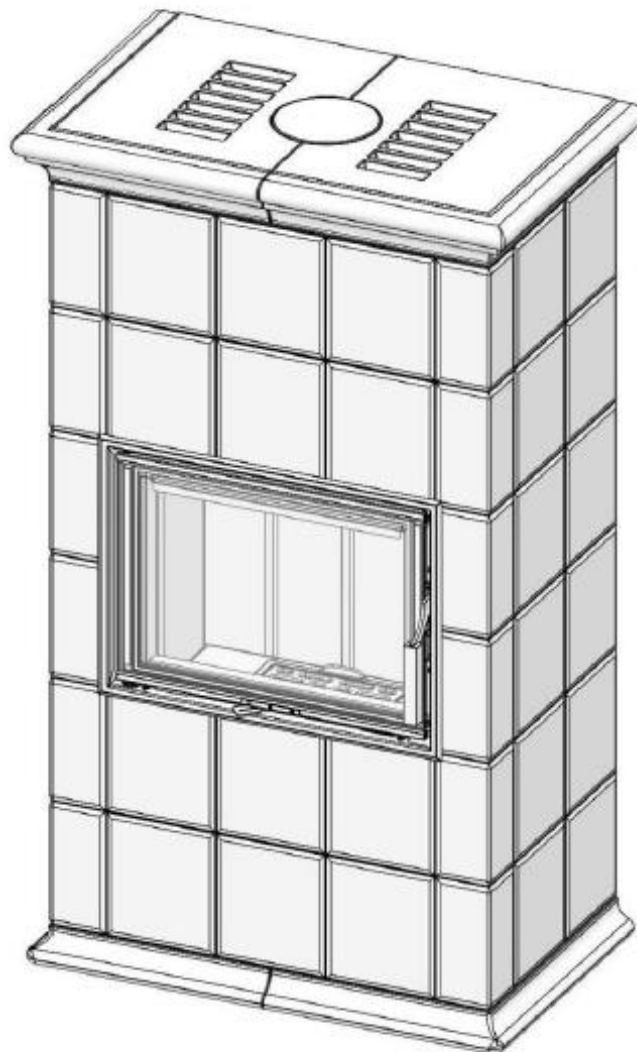

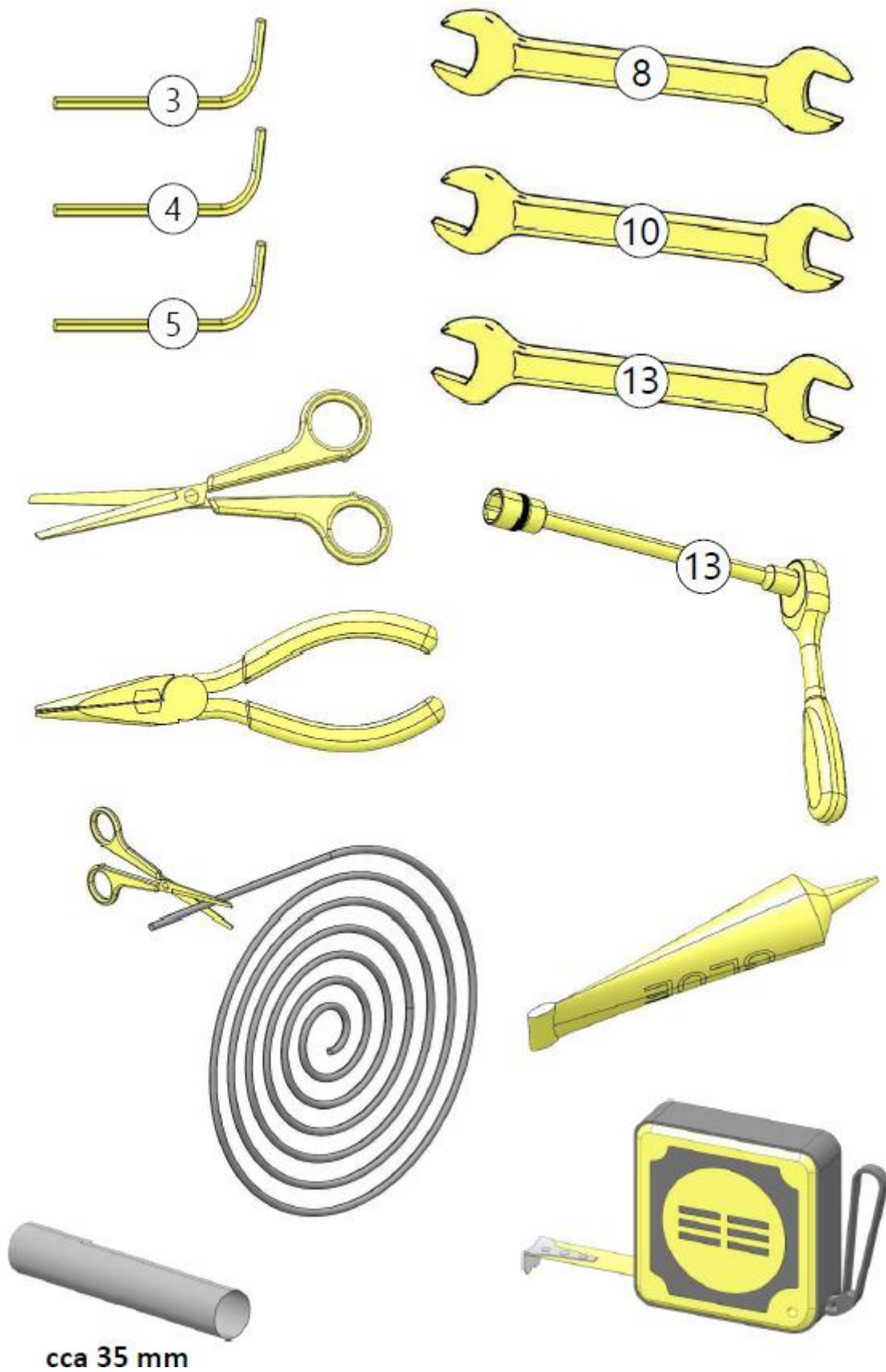

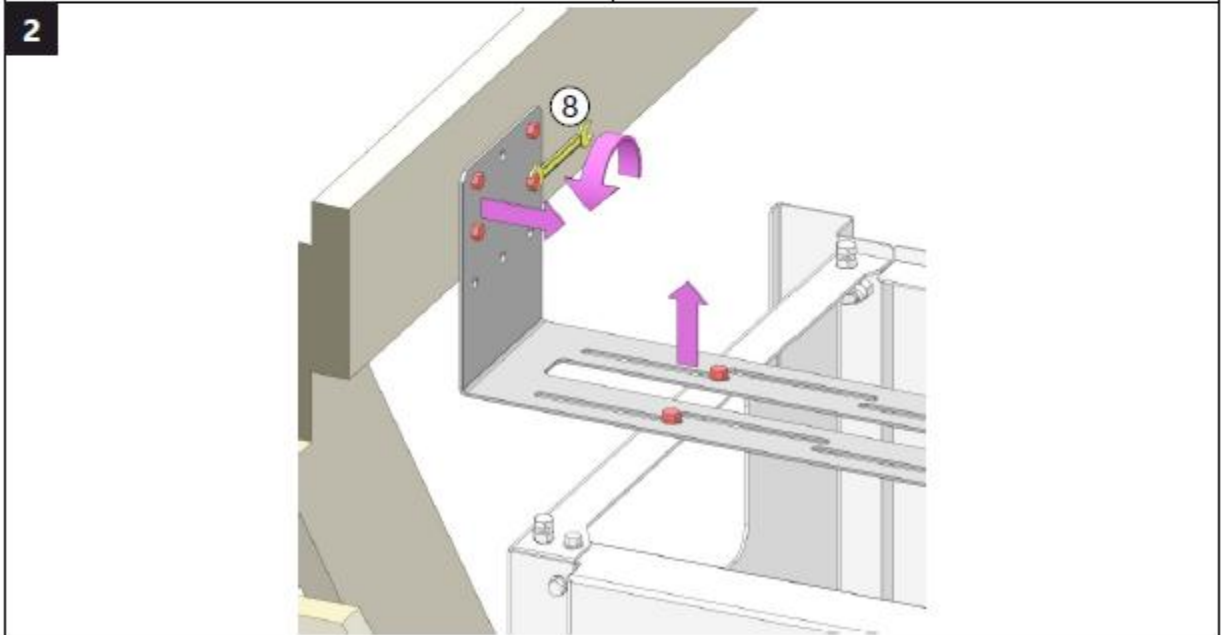
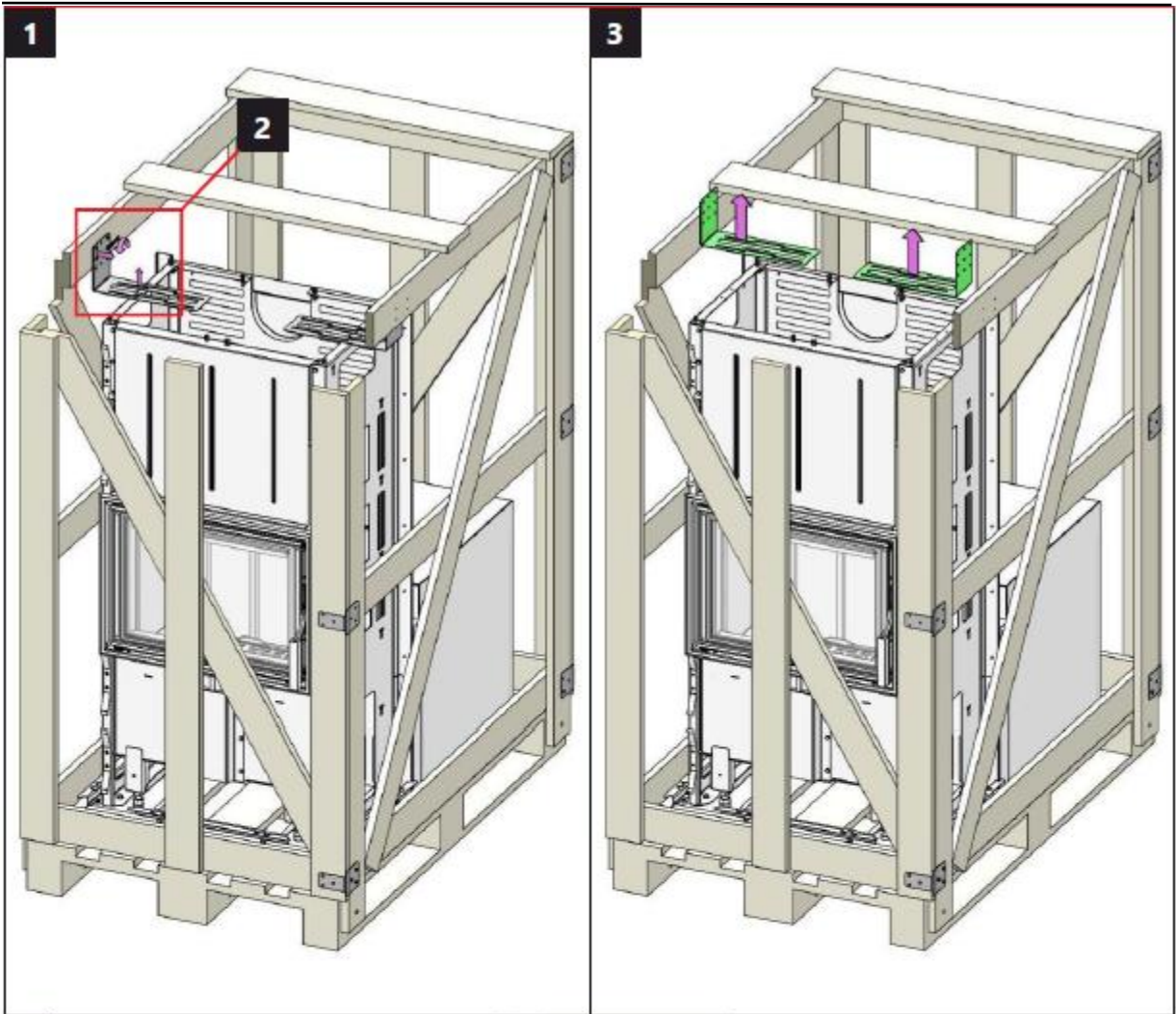

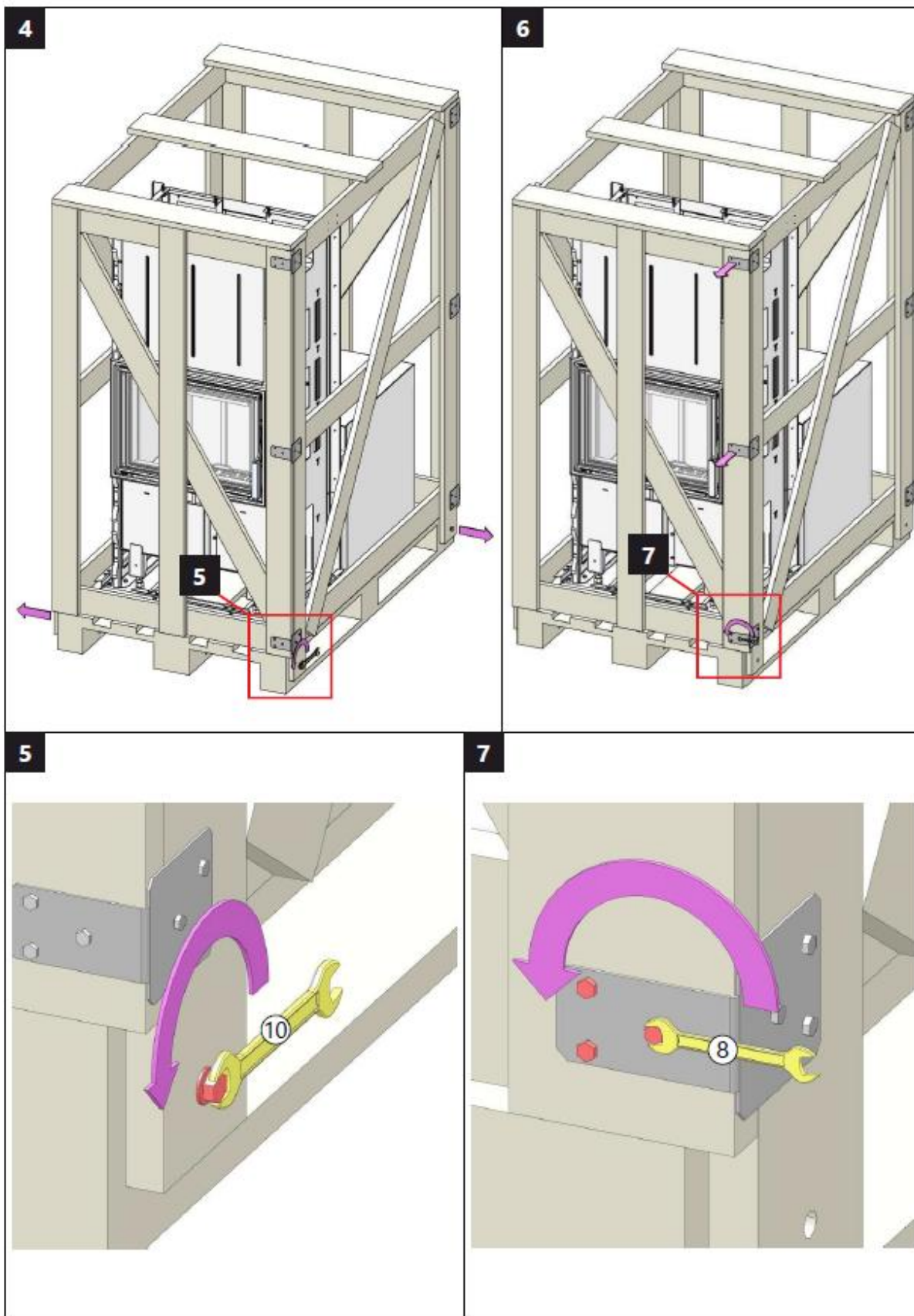

8

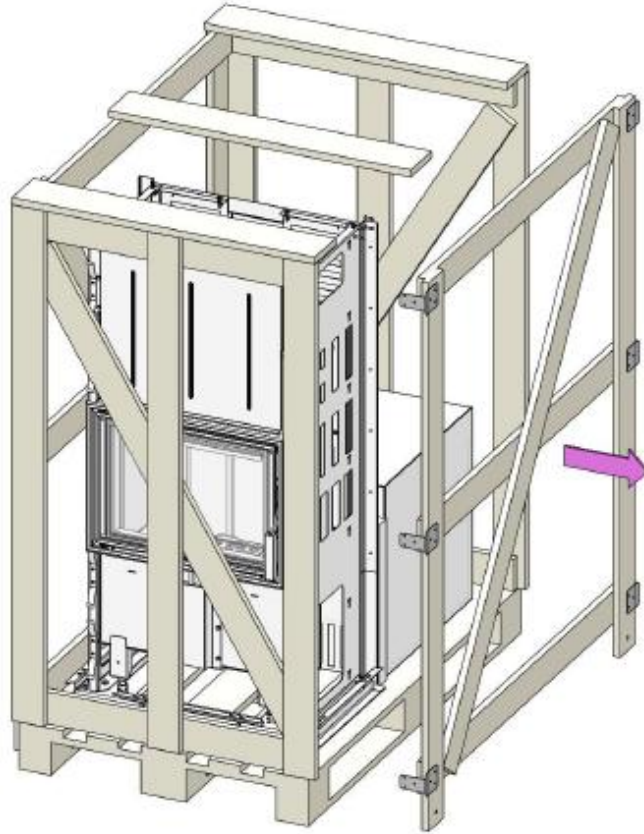

9

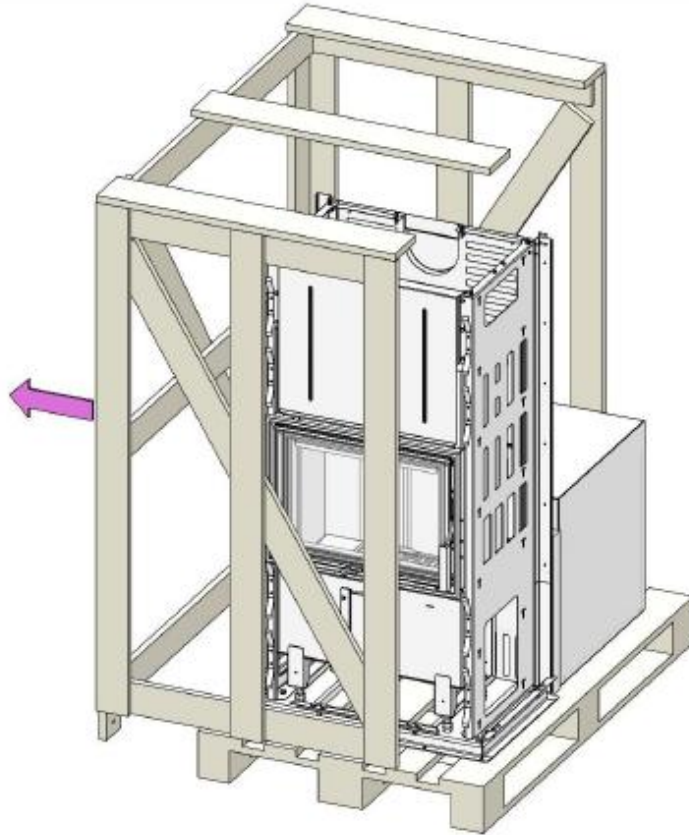

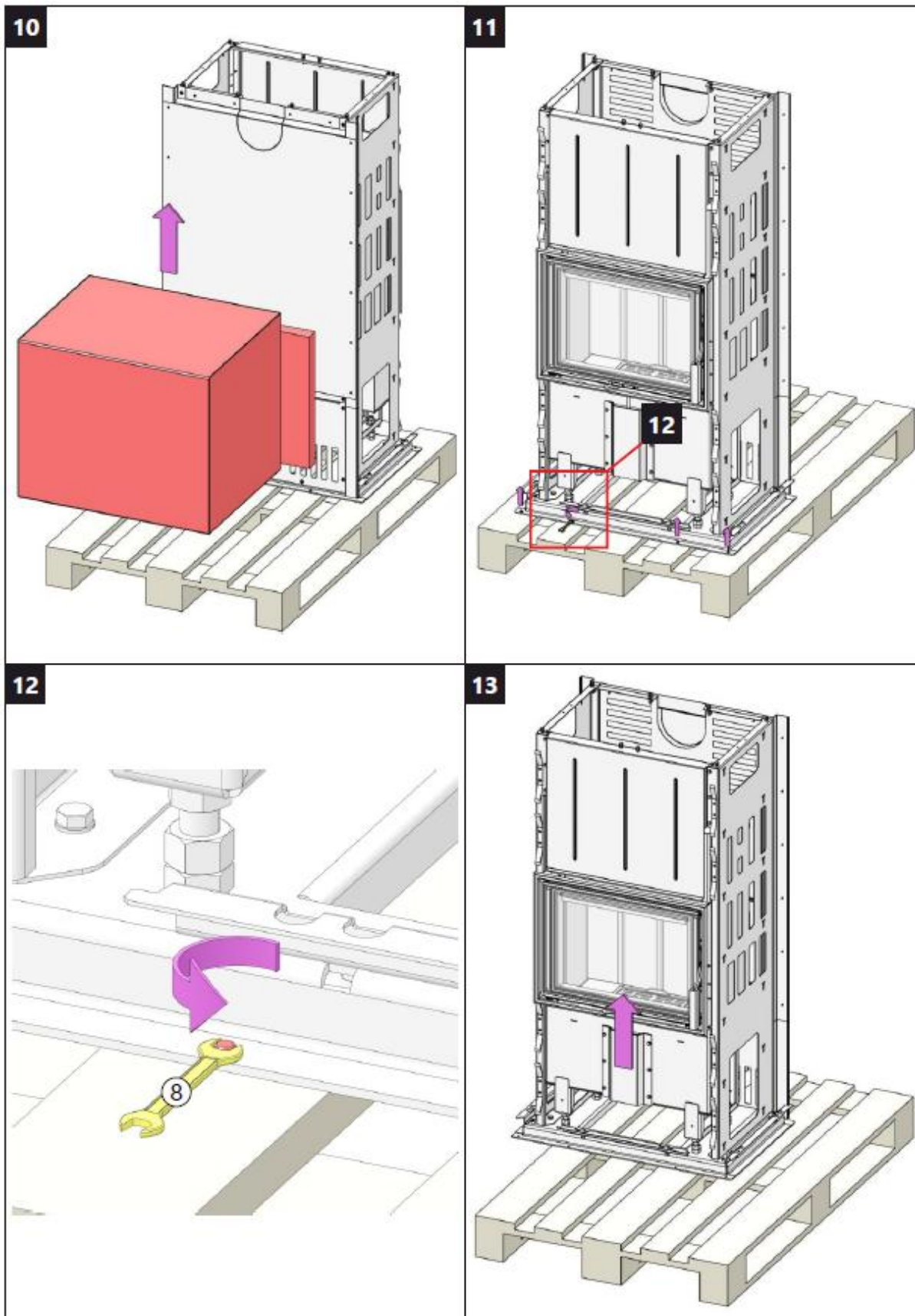

14

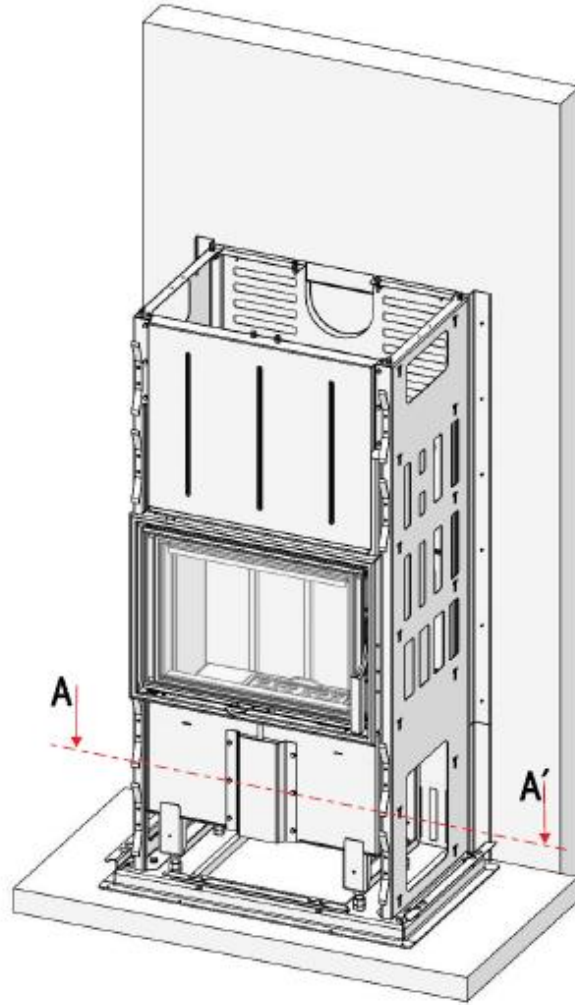

A - A'

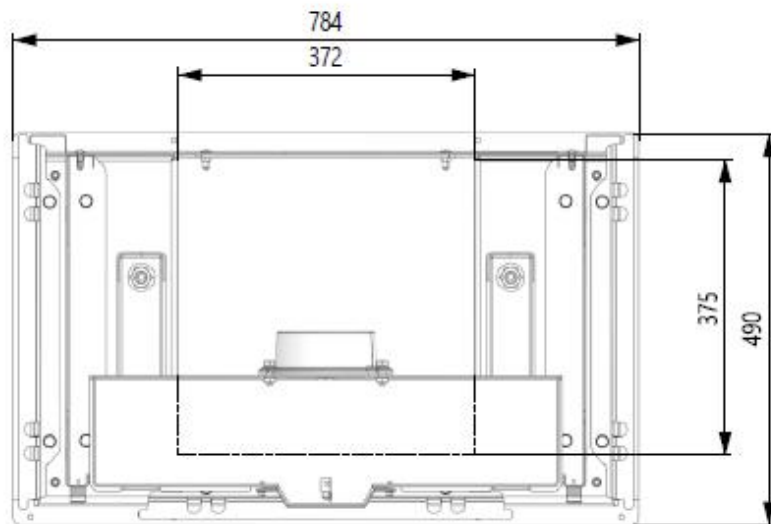

15

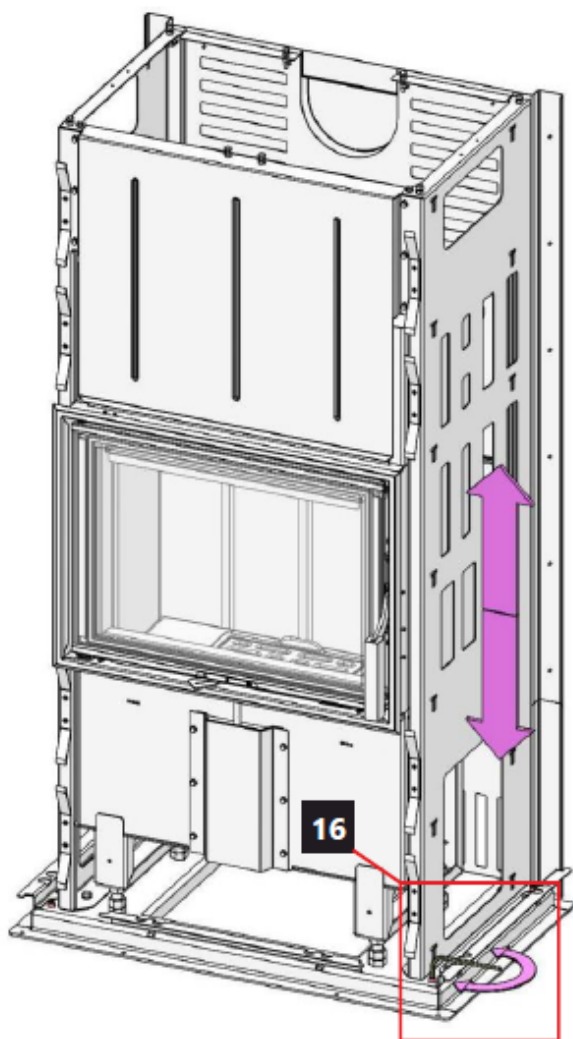



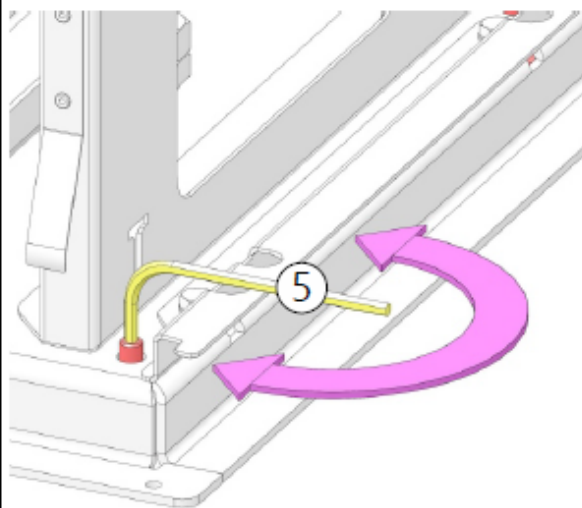



16

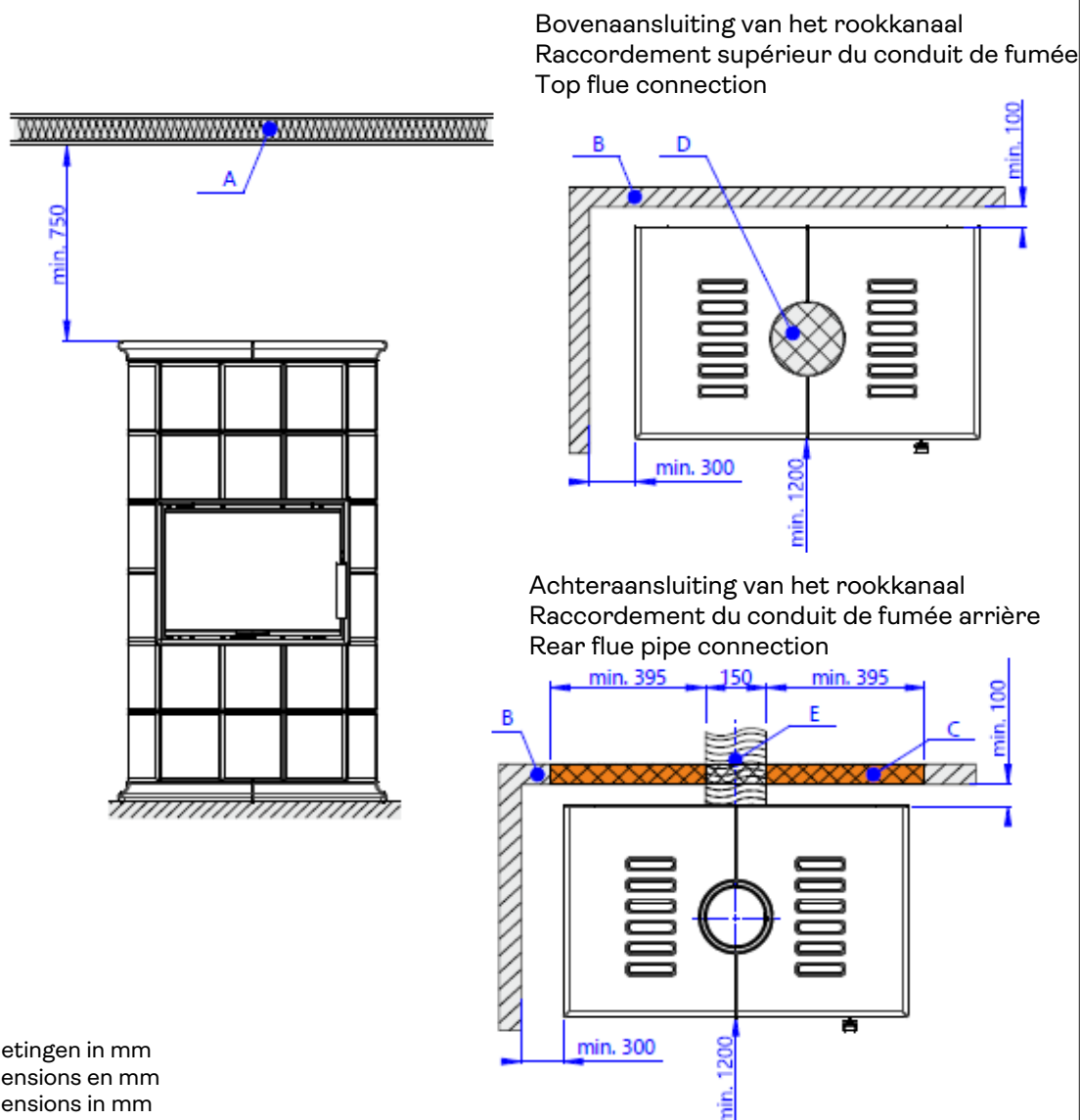

**17**

**Veiligheidsafstand tot brandbare materialen**  
**Distance de sécurité par rapport aux matériaux inflammables**  
**Safety distance from flammable materials**



A		Brandbaar plafond	Plafond inflammable	Flammable ceiling
B		Brandbare muur	Mur inflammable	Flammable wall
C		Isolatiebescherming (muur)	Protection isolante (mur)	Protective insulation (wall)
D		Rookkanaal zonder isolatie	Conduit de fumée sans isolation	Flue without insulation
E		Achteraansluiting	Raccordement arrière	Rear connection

De installatie moet altijd in overleg met een schoorsteenveger plaatsvinden en alle lokale voorschriften moeten worden nageleefd, inclusief voorschriften die betrekking hebben op nationale en Europese normen!

L'installation doit toujours être effectuée en concertation avec un ramoneur et toutes les réglementations locales doivent être respectées, y compris celles relatives aux normes nationales et européennes !

Installation must always be carried out in consultation with a chimney sweep, and all local regulations must be complied with, including those relating to national and European standards!

18

**Veiligheidsafstand tot onbrandbare materialen**  
**Distance de sécurité par rapport aux matériaux incombustibles**  
**Safety distance from non-flammable materials**

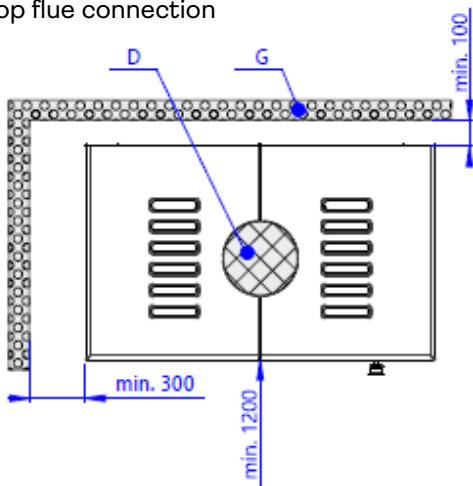

Bovenaansluiting van het rookkanaal  
 Raccordement supérieur du conduit de fumée  
 Top flue connection

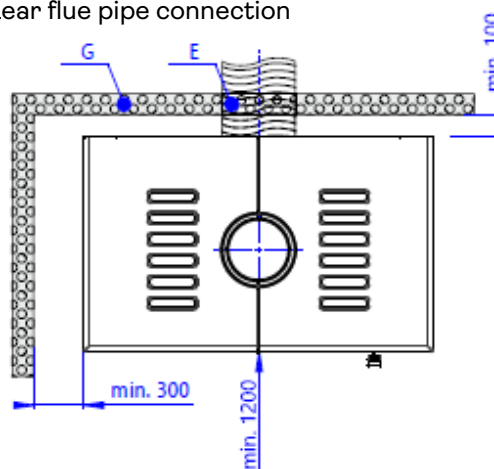

Achteraansluiting van het rookkanaal  
 Raccordement du conduit de fumée arrière  
 Rear flue pipe connection



Afmetingen in mm  
 Dimensions en mm  
 Dimensions in mm

D		Rookkanaal zonder isolatie	Conduit de fumée sans isolation	Flue without insulation
E		Achteraansluiting	Raccordement arrière	Rear connection
G		Onbrandbare wand	Mur ininflammable	Non-flammable wall

De installatie moet altijd in overleg met een schoorsteenveger plaatsvinden en alle lokale voorschriften moeten worden nageleefd, inclusief voorschriften die betrekking hebben op nationale en Europese normen!

L'installation doit toujours être effectuée en concertation avec un ramoneur et toutes les réglementations locales doivent être respectées, y compris celles relatives aux normes nationales et européennes !

Installation must always be carried out in consultation with a chimney sweep, and all local regulations must be complied with, including those relating to national and European standards!

Aansluitmogelijkheden - Options de connexion - Connection options

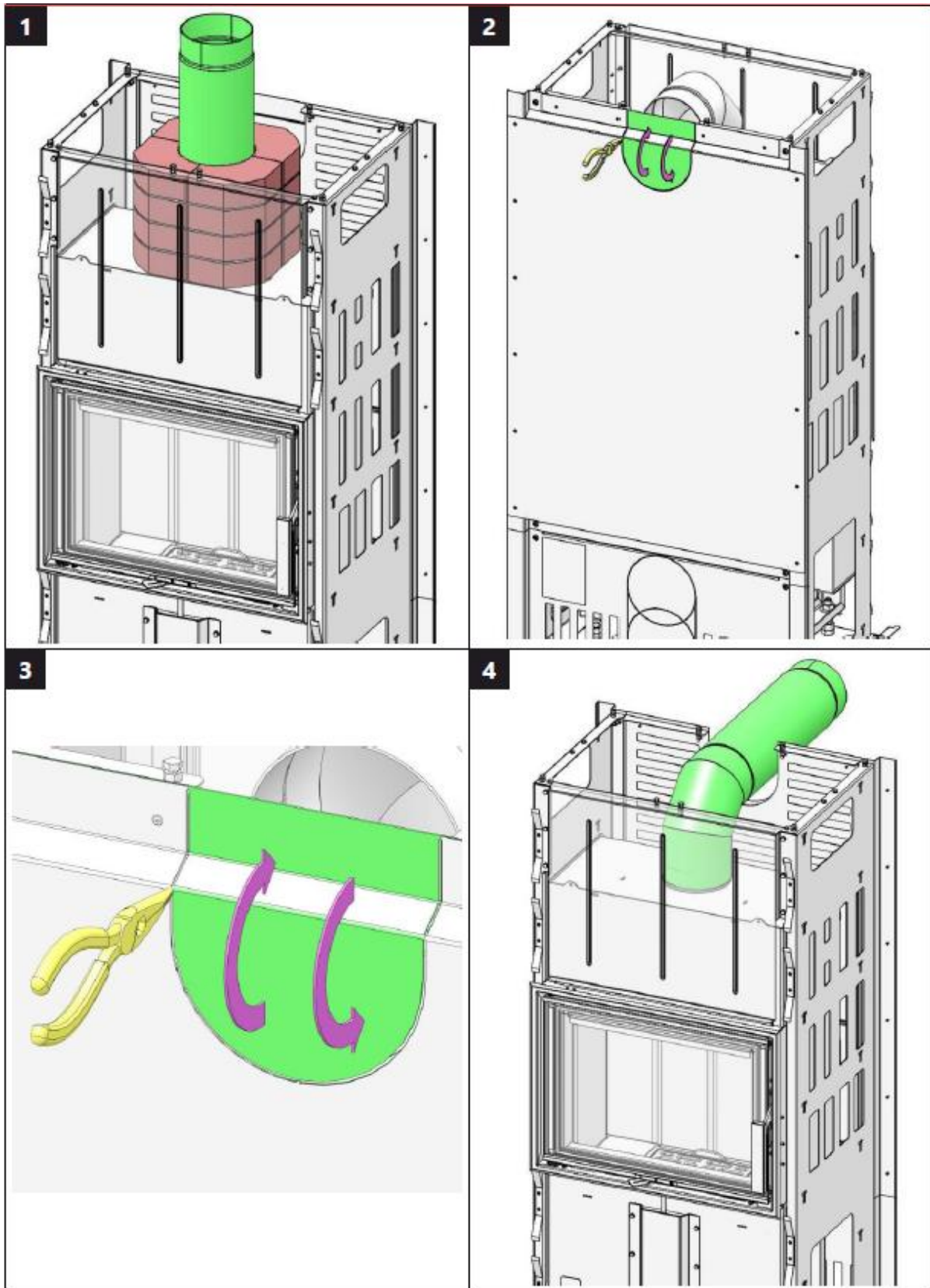

Achteraansluiting  
Raccordement arrière  
Rear connection

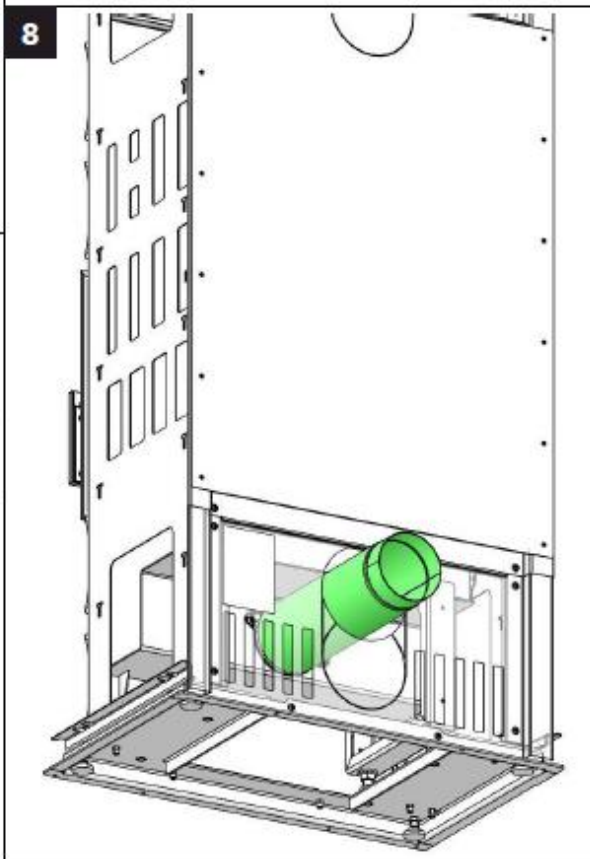
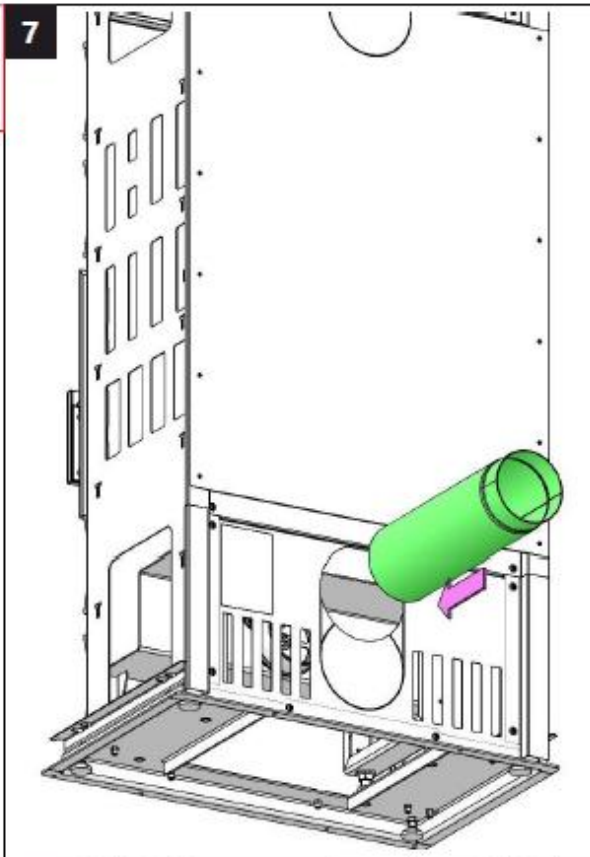
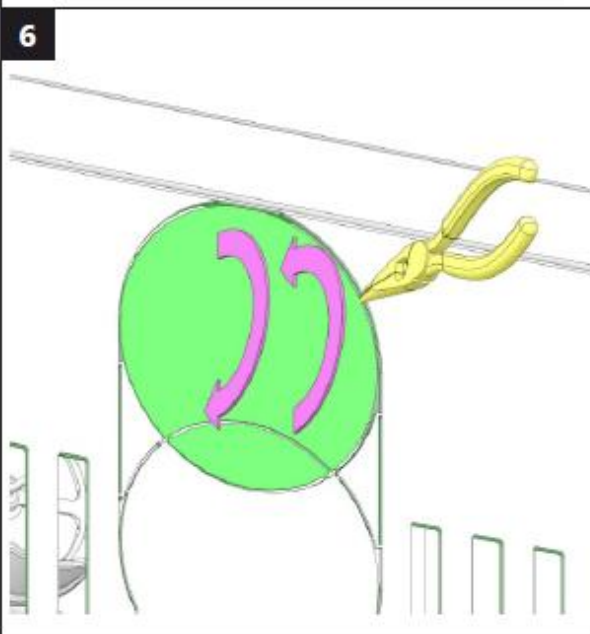
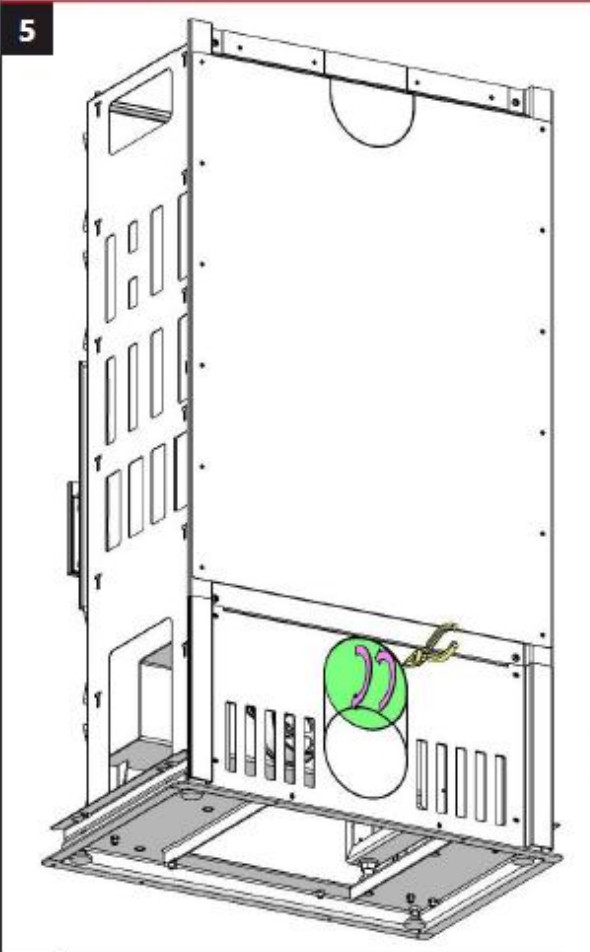

Onderaansluiting  
Raccordement par le bas  
Bottom connection

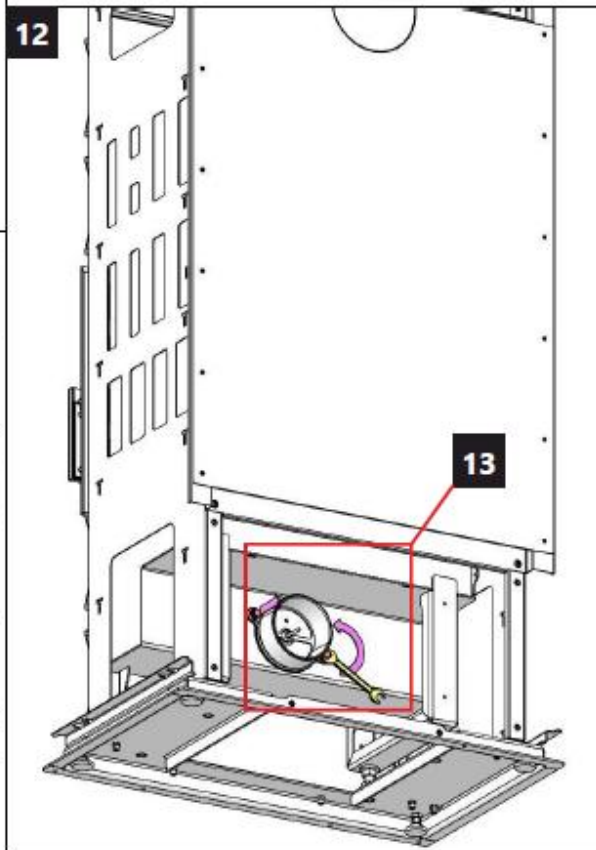
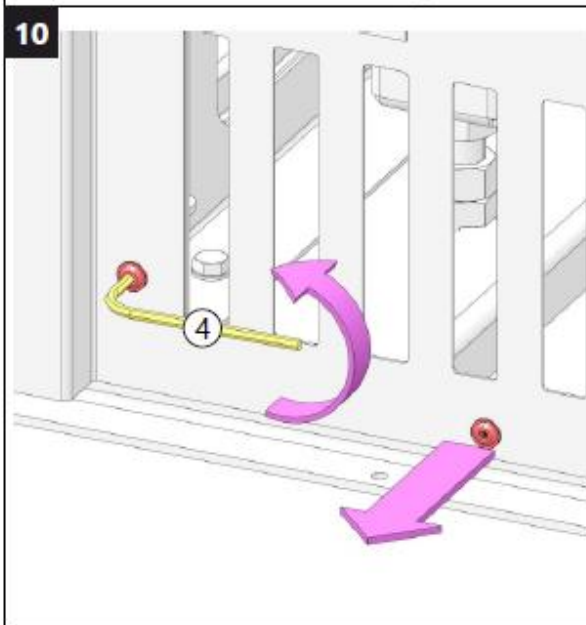
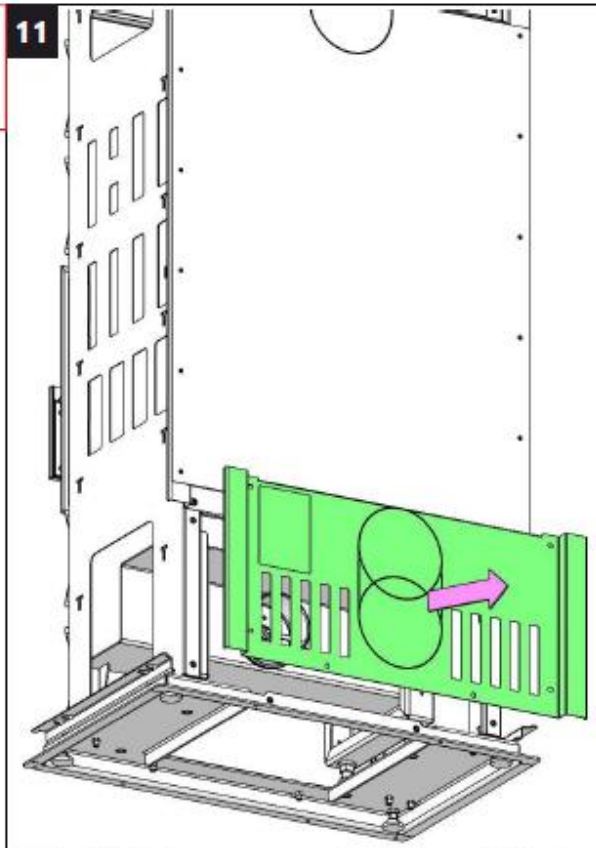
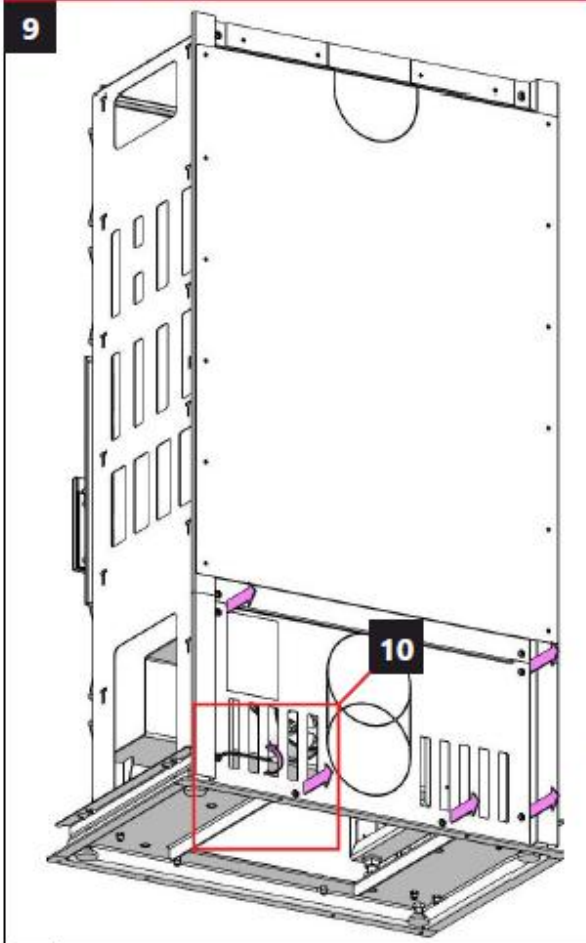

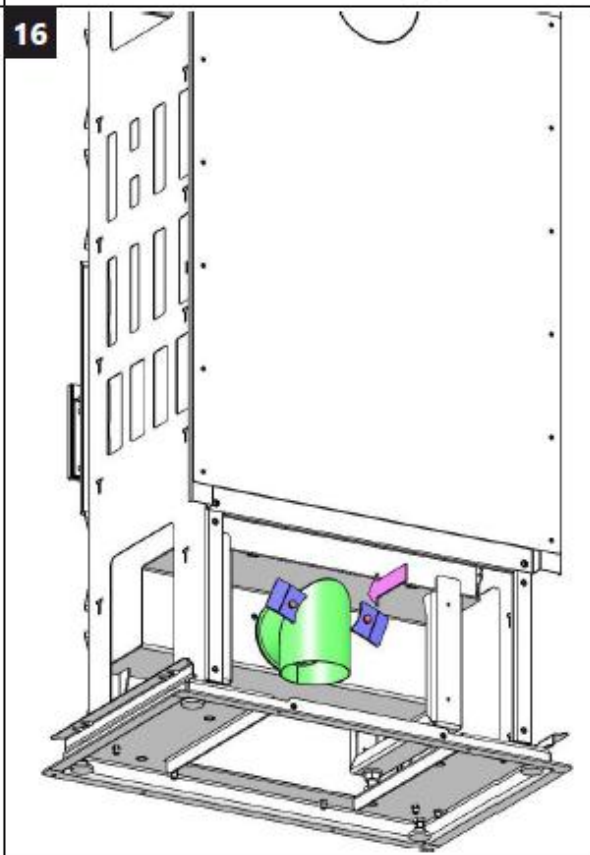
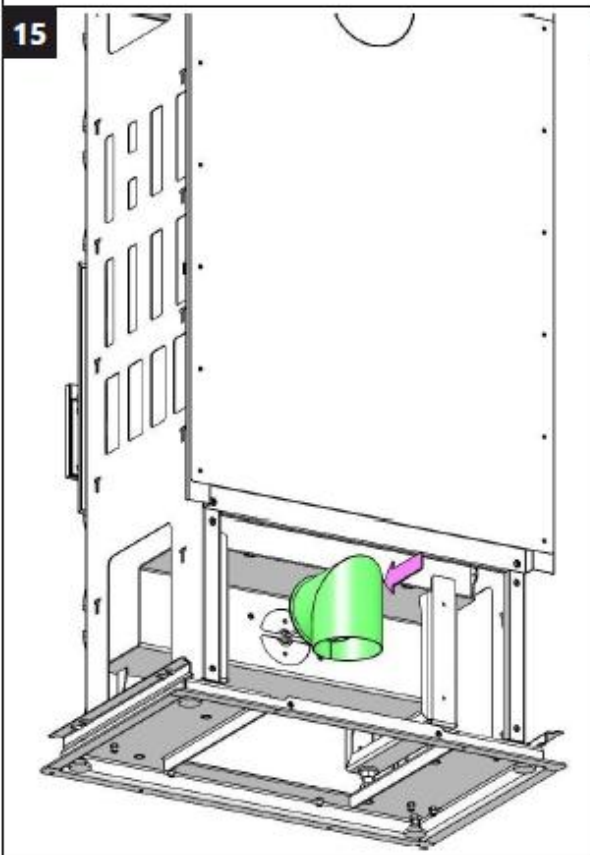
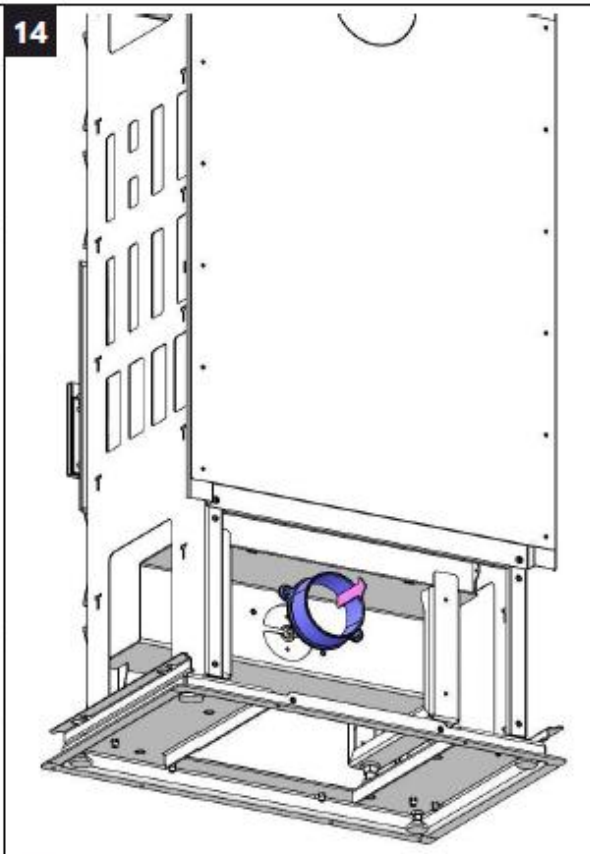
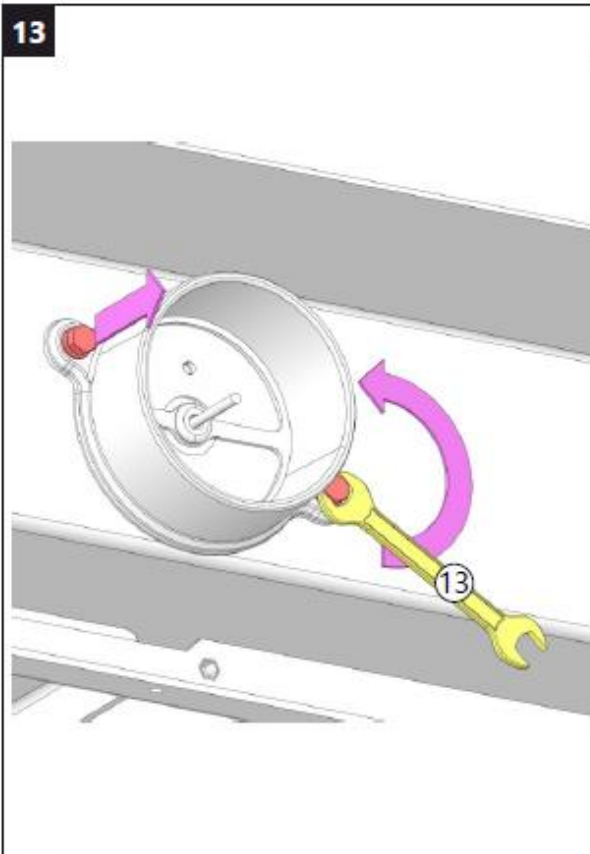

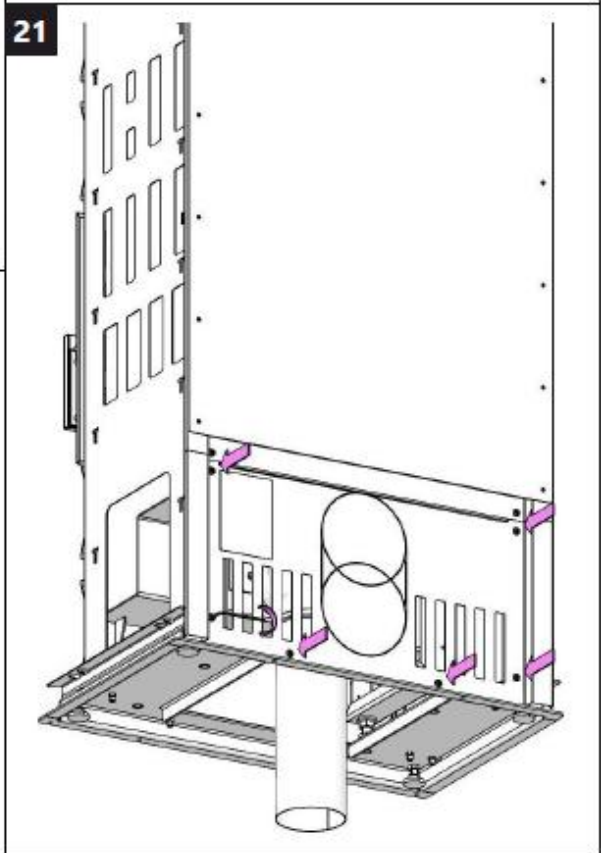
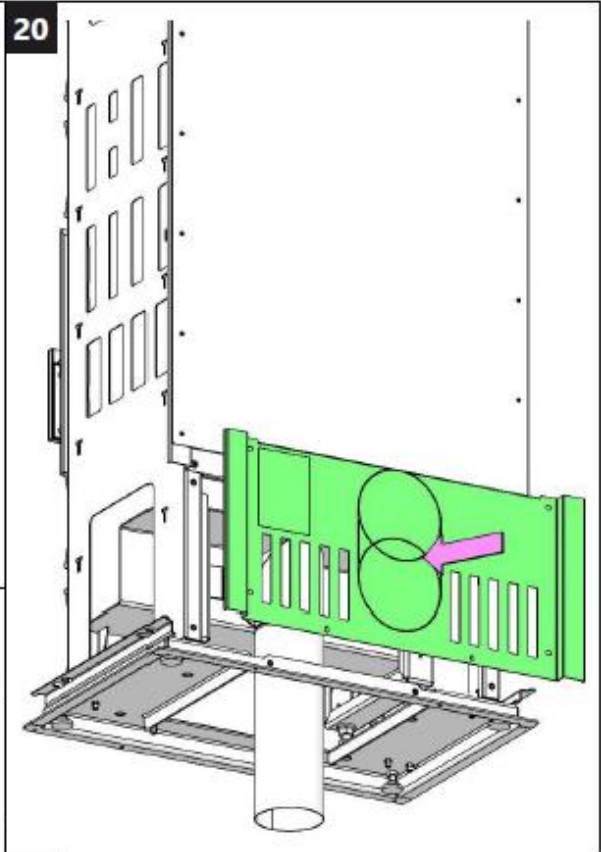
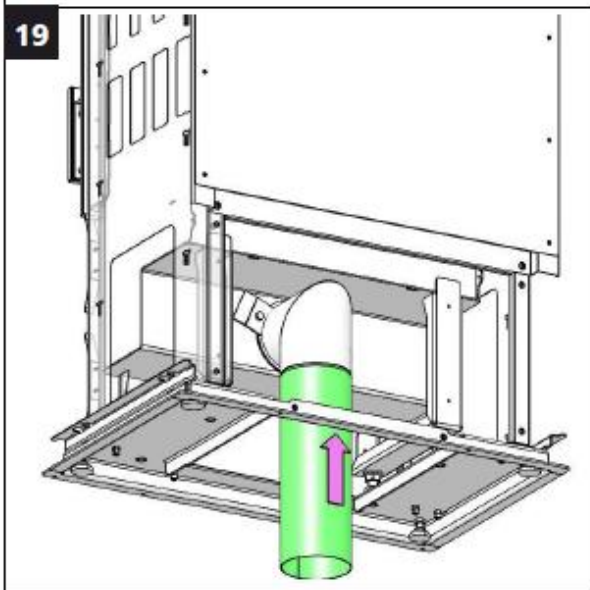
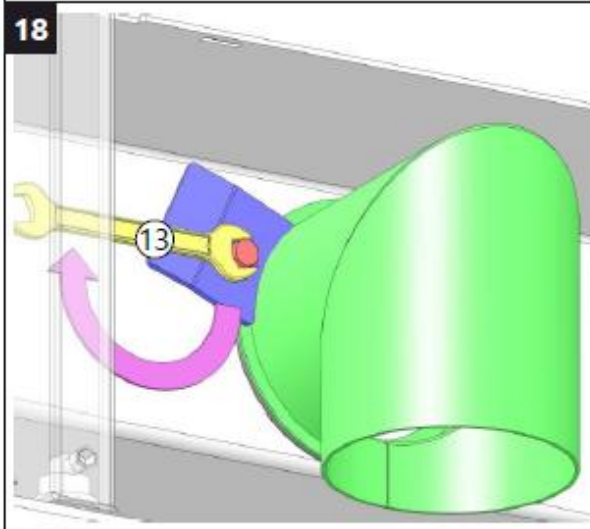
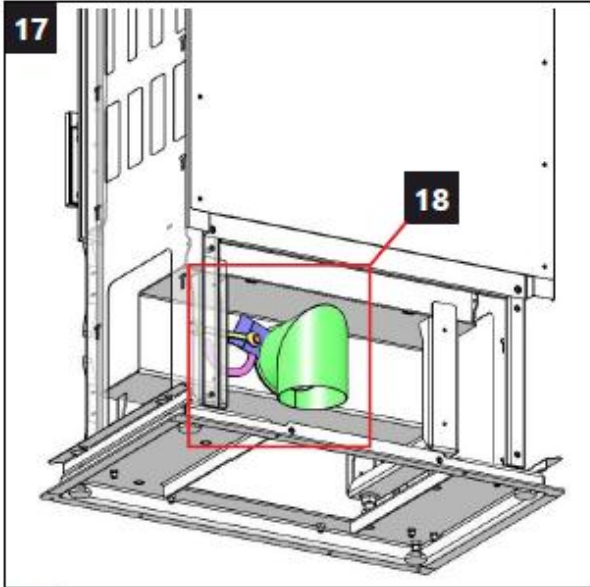

OPTIE – OPTION- OPTION : Accumulatie – Accumulation - Accumulation

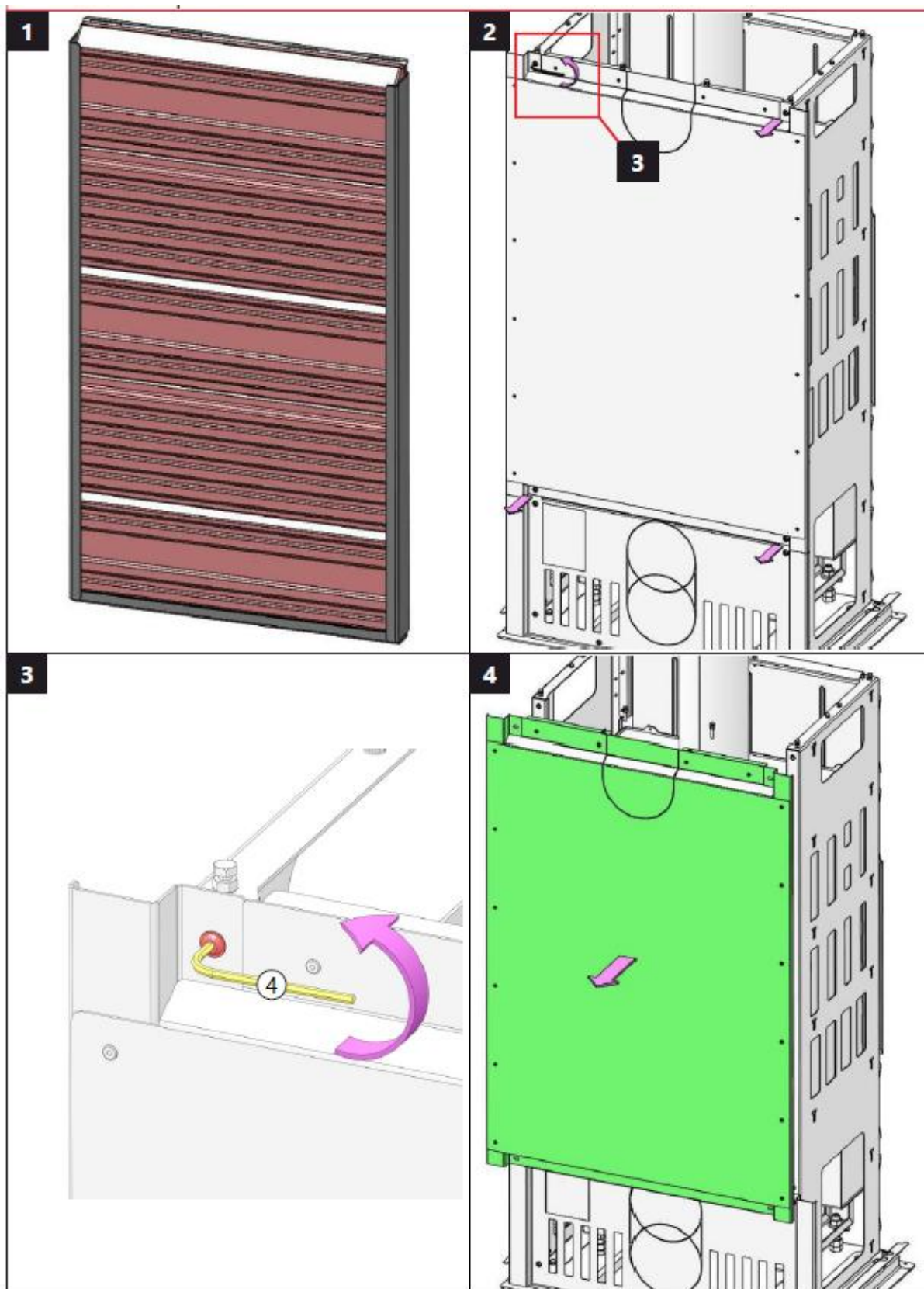



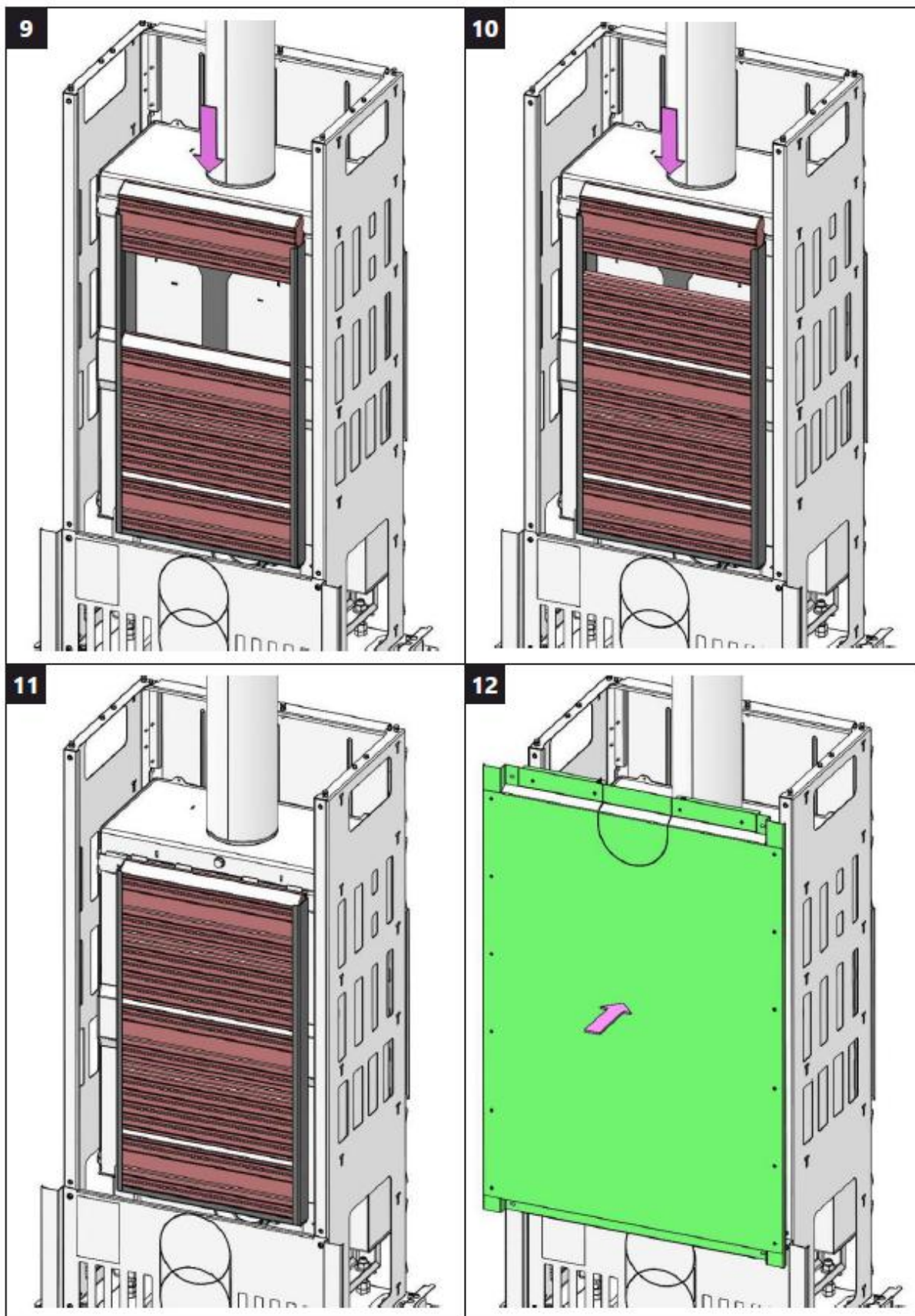

13

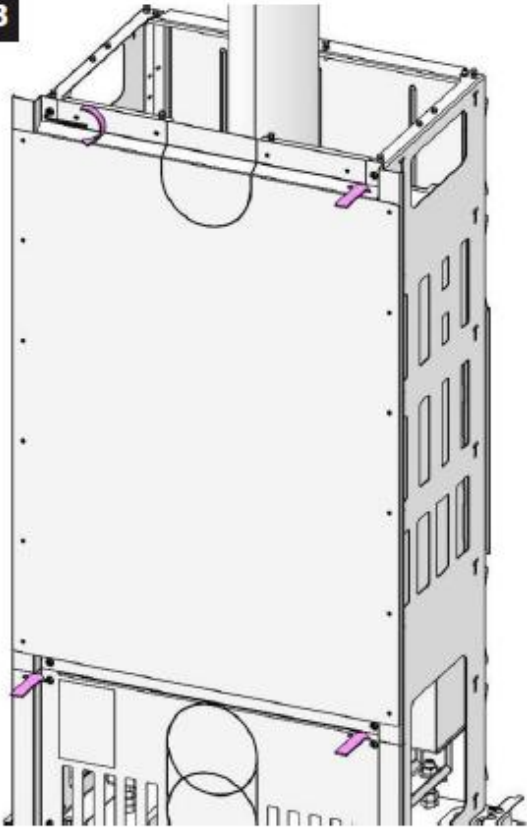

14

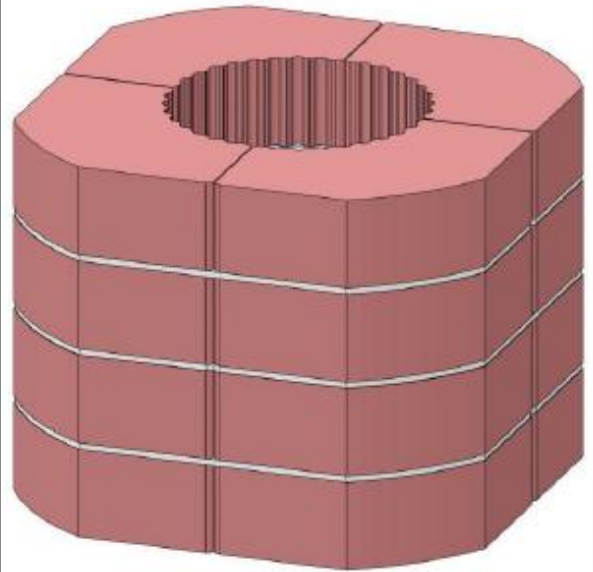

15

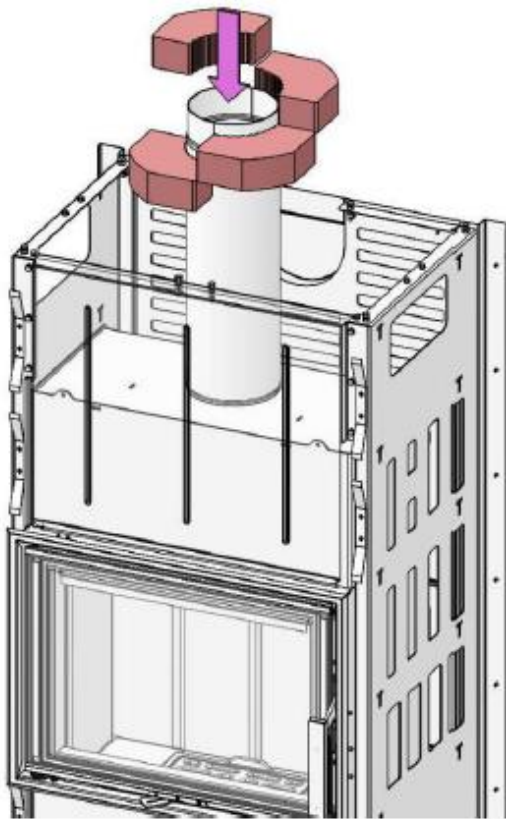

16

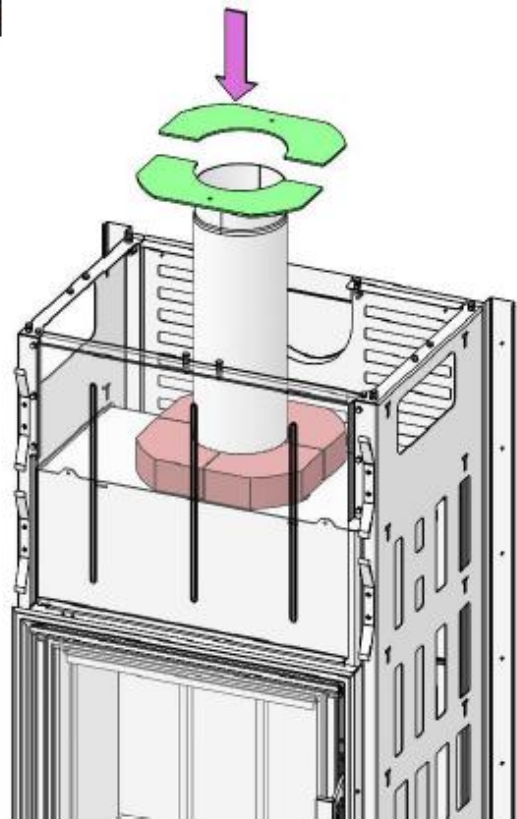

17

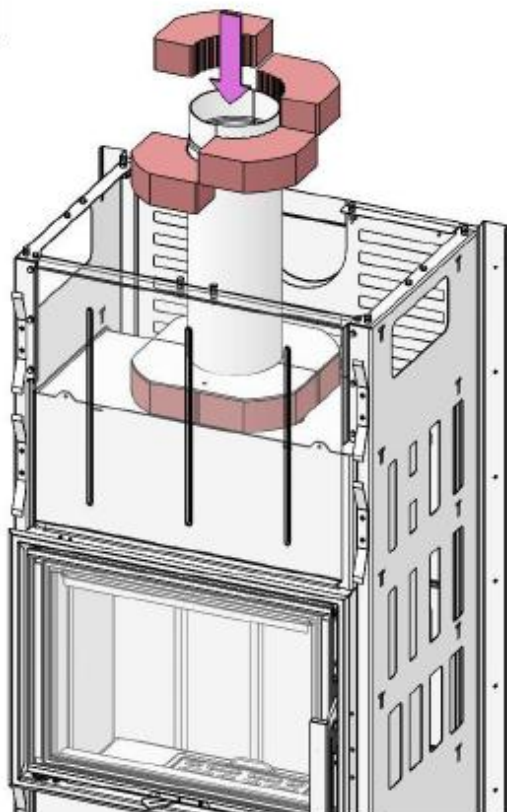

18

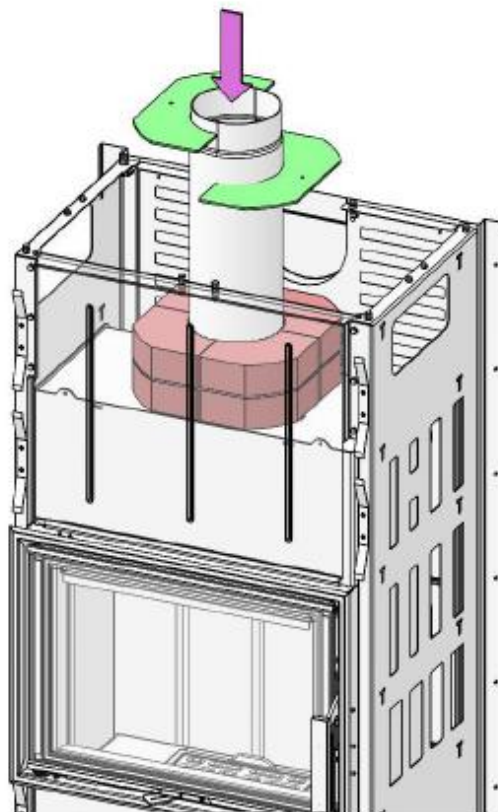

19

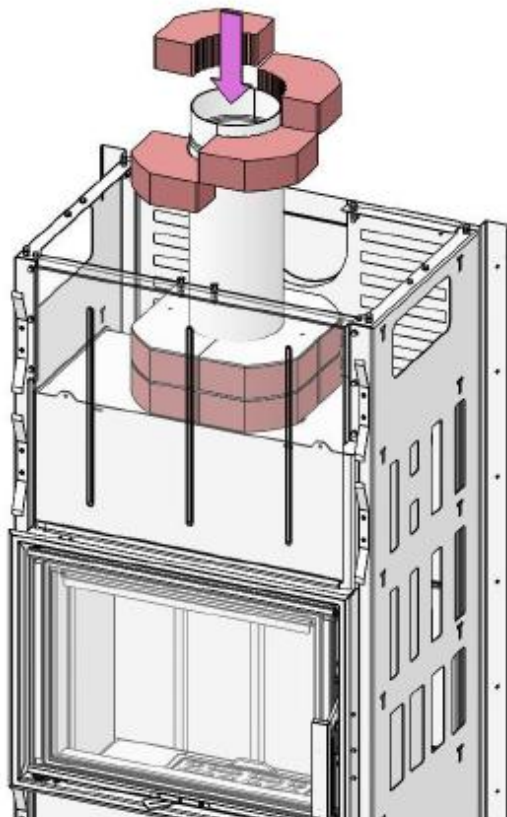

20

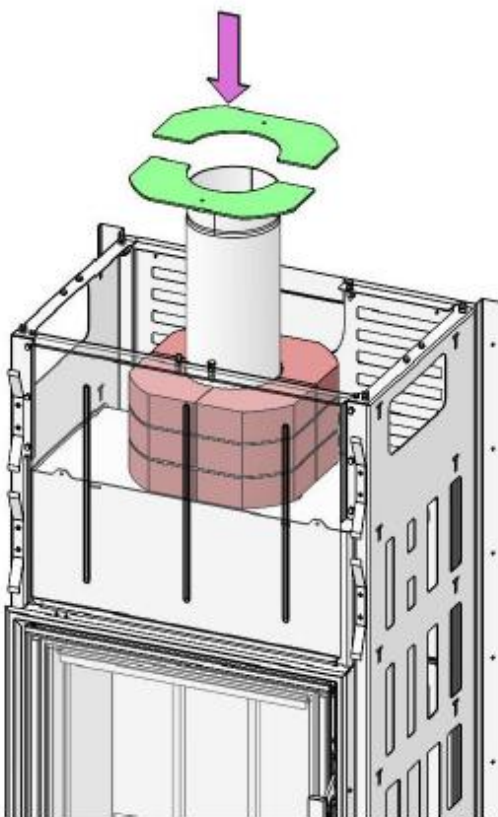

21

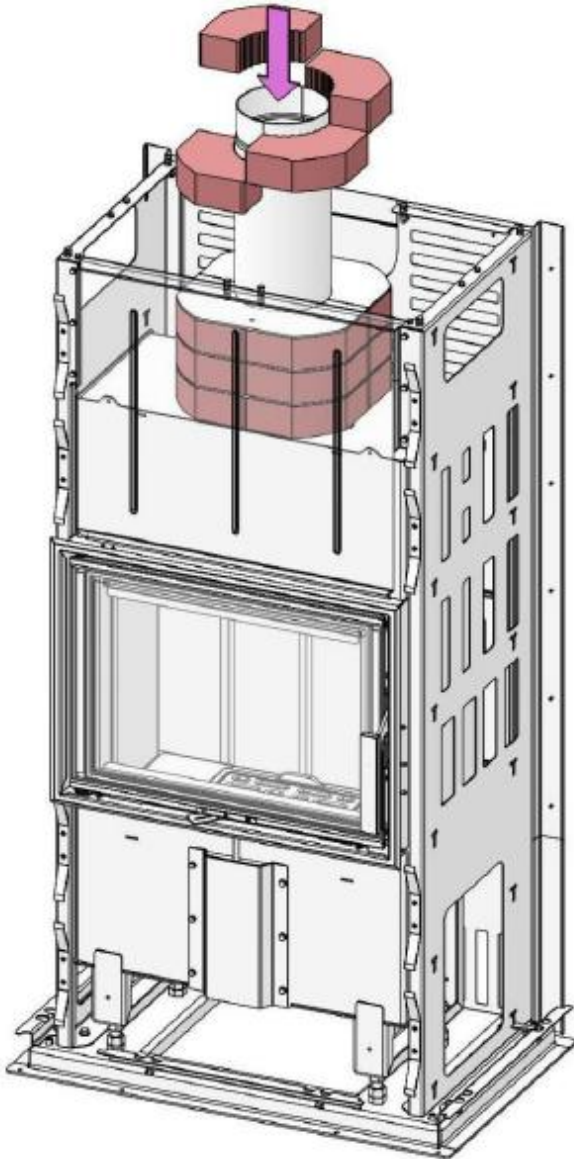

22

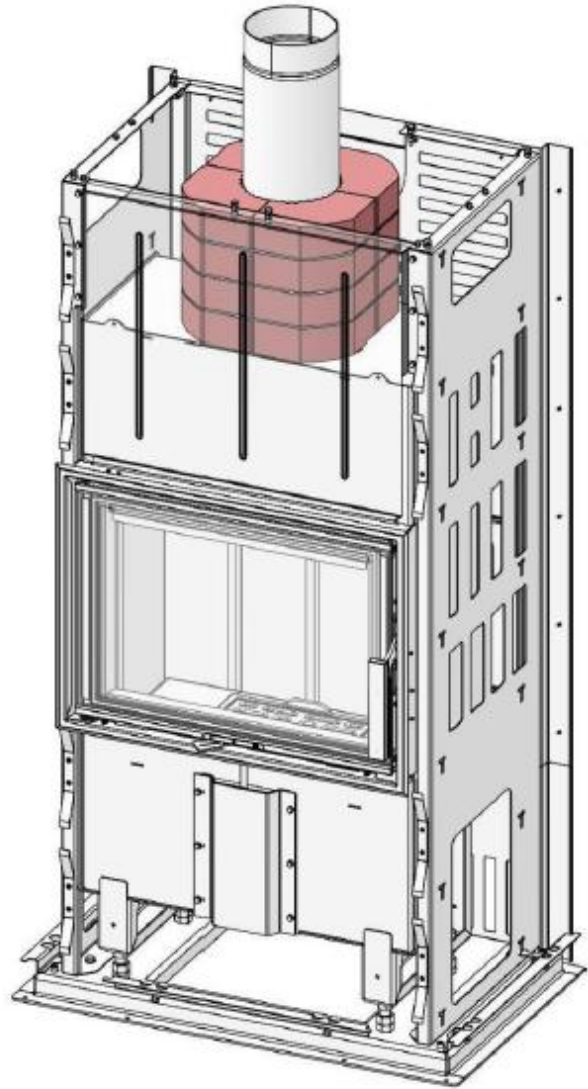

Accessoires - Accessories

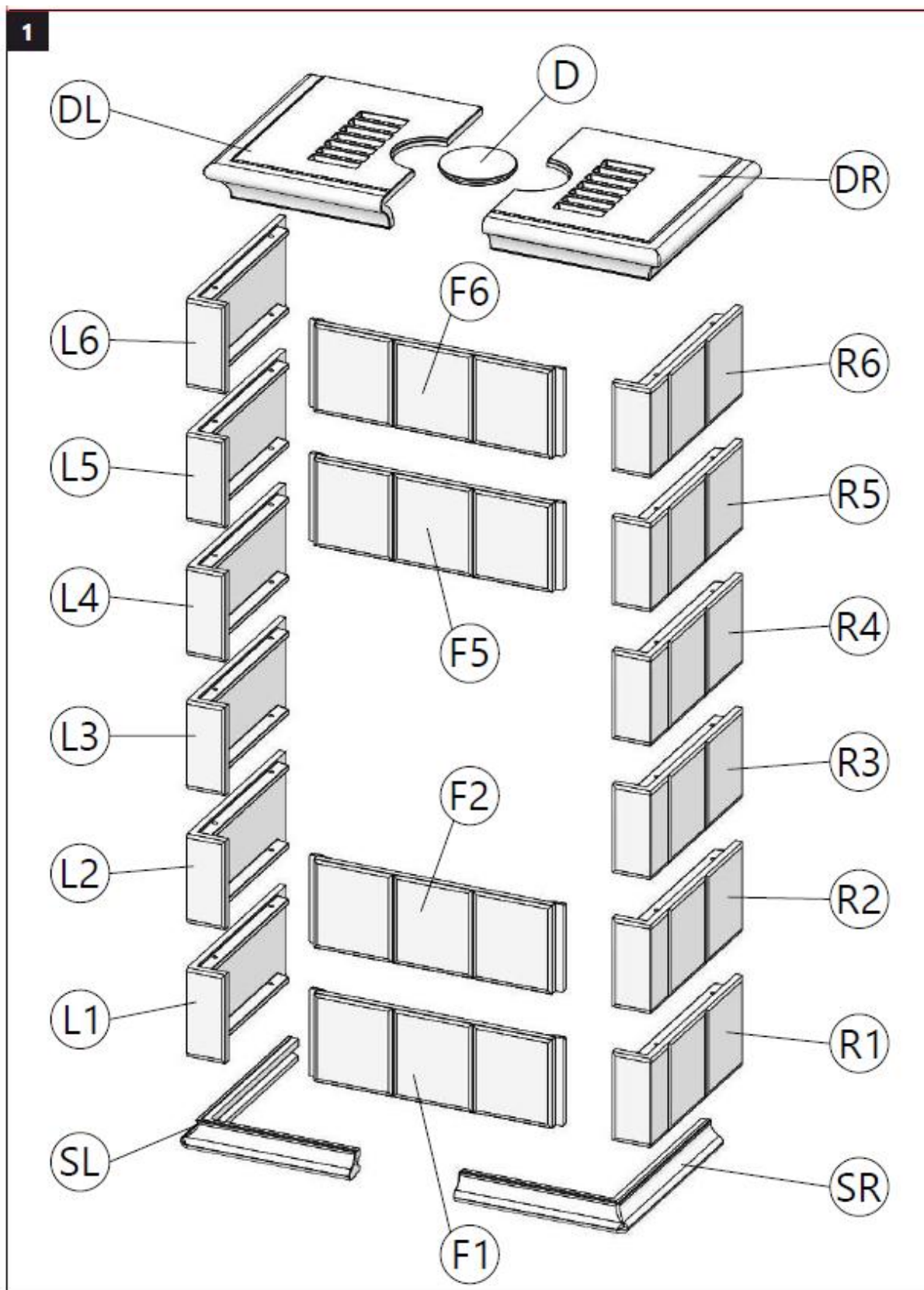

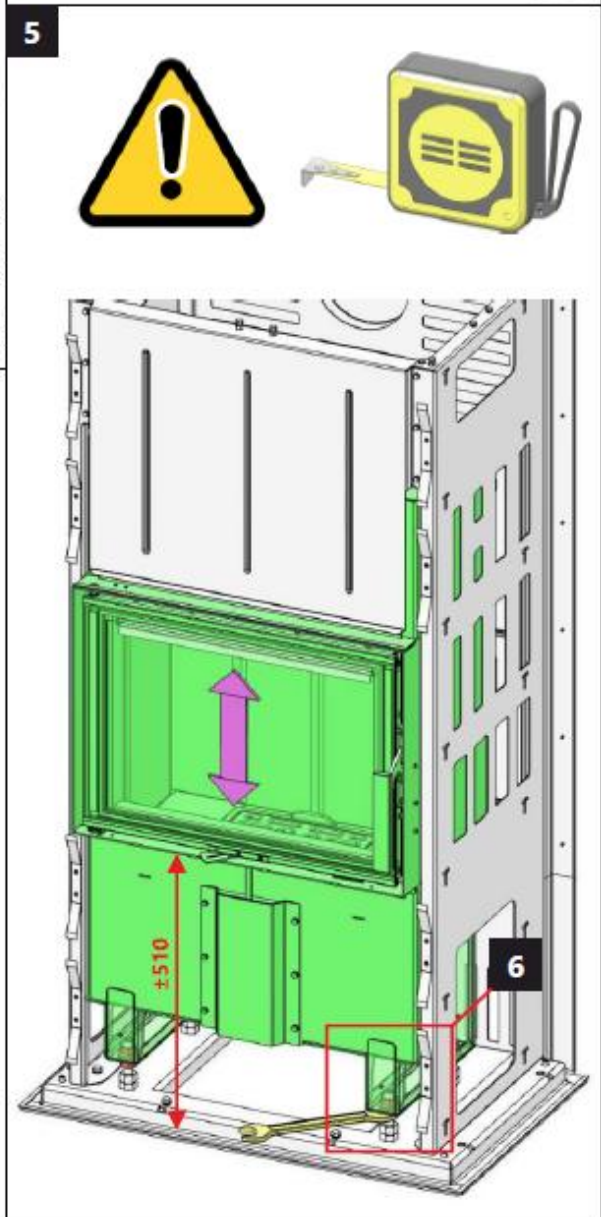
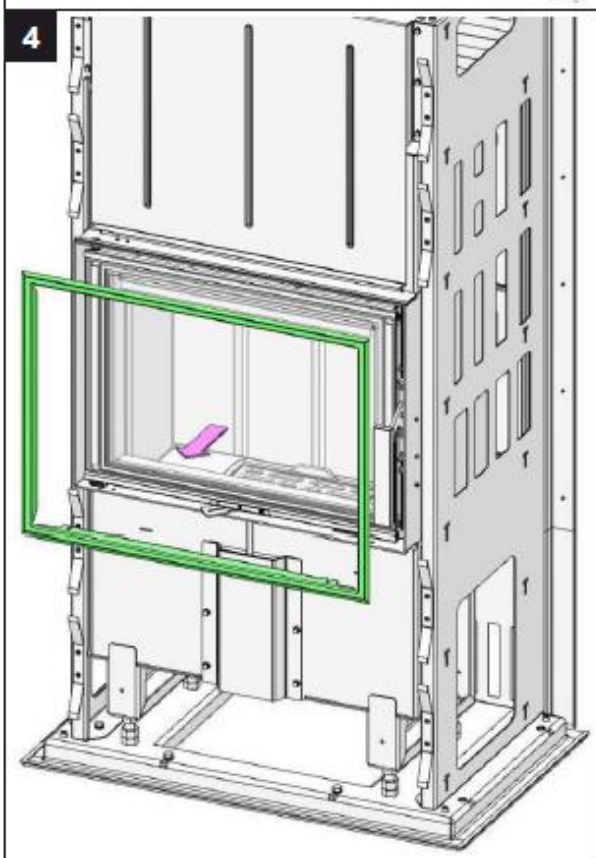
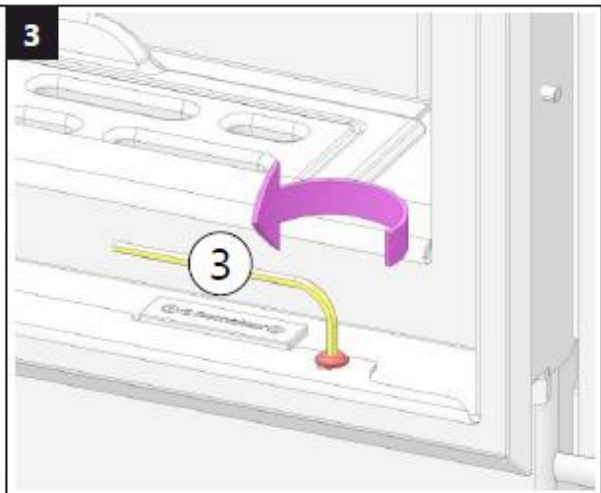
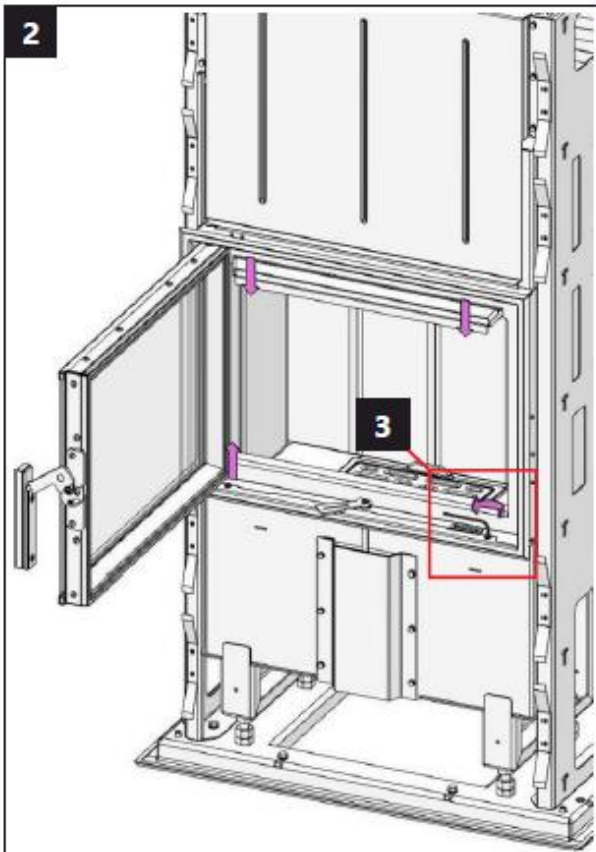

★ Dichtingskoord - Cordon d'étanchéité - Sealing cord

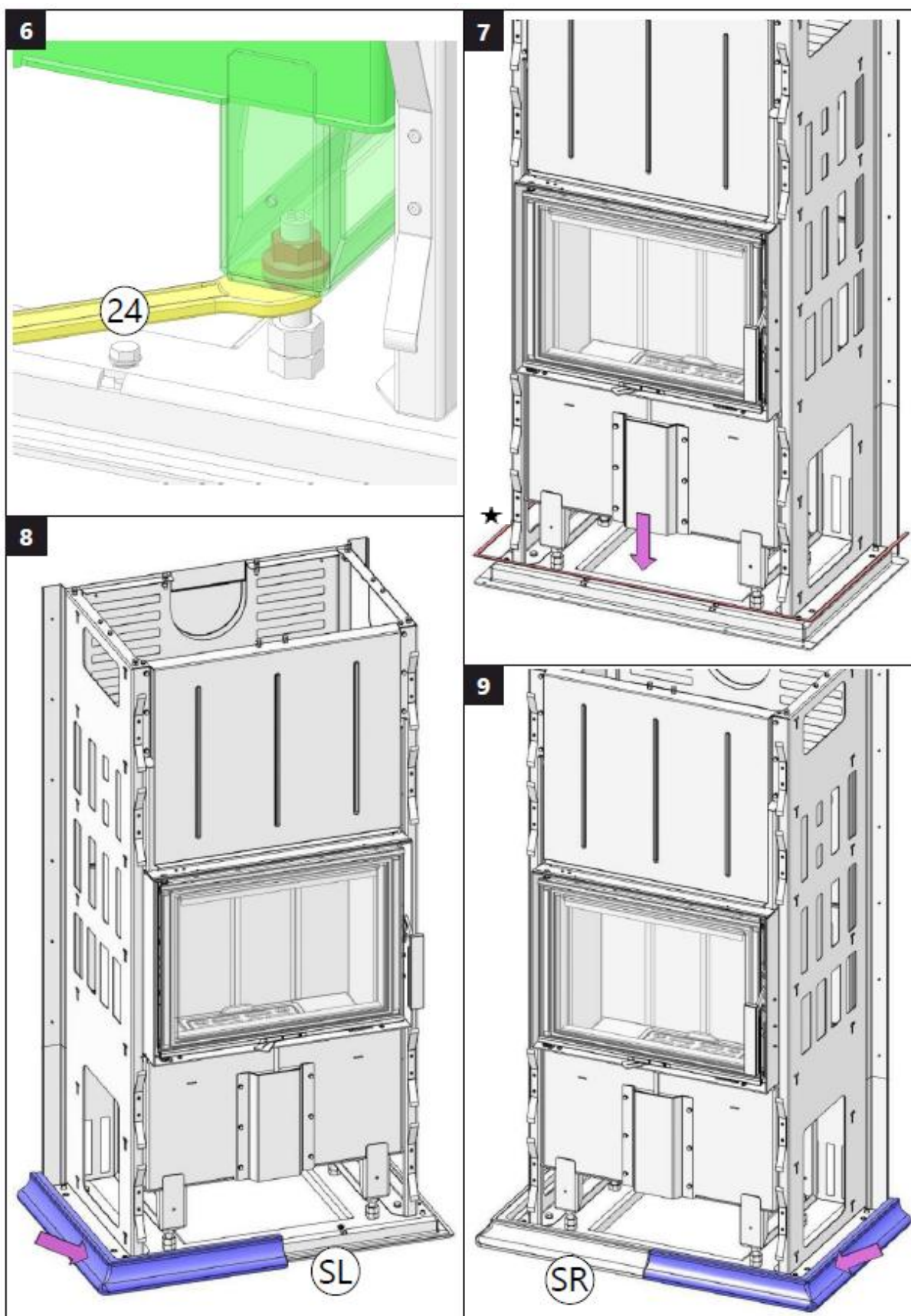

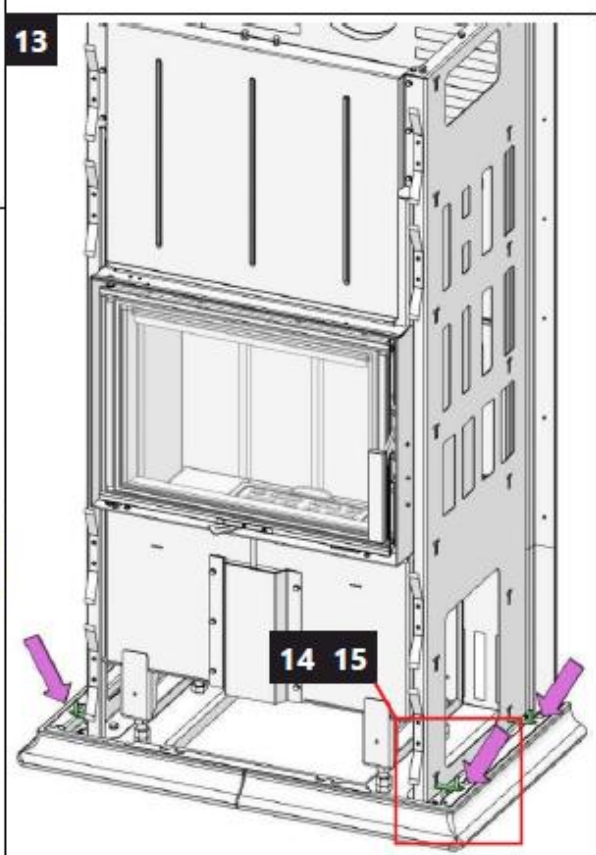
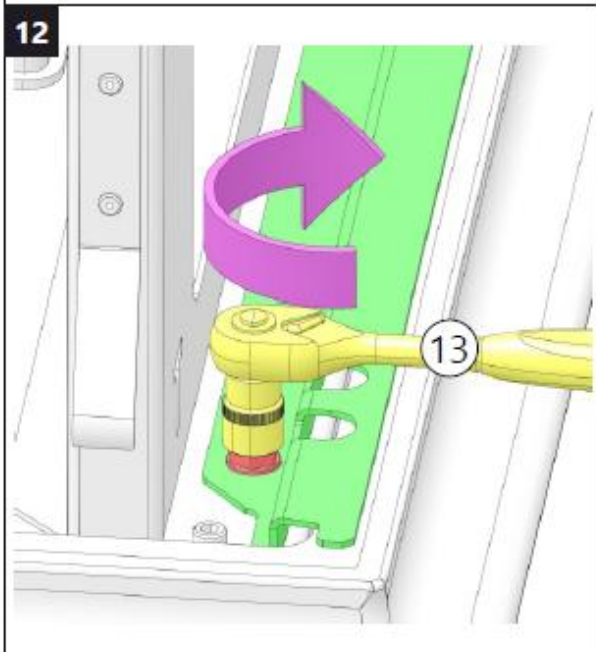
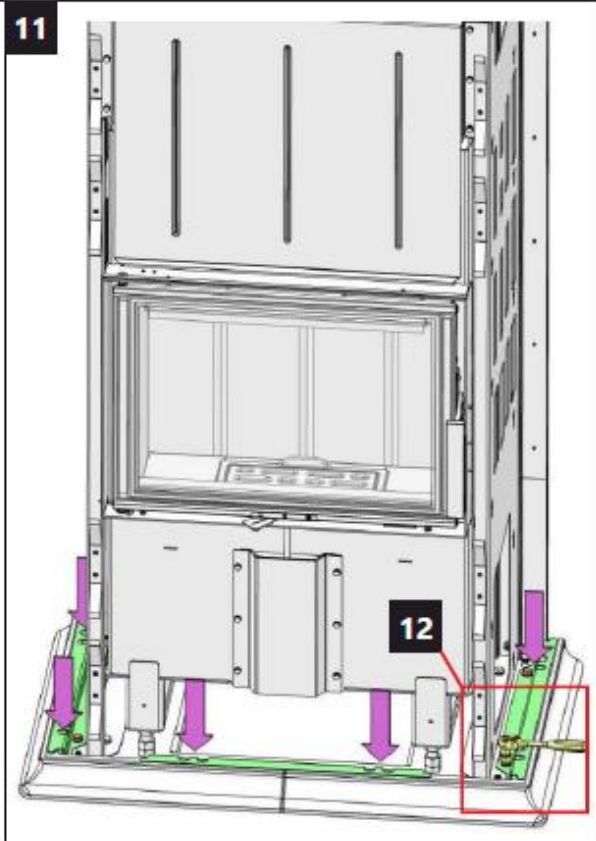
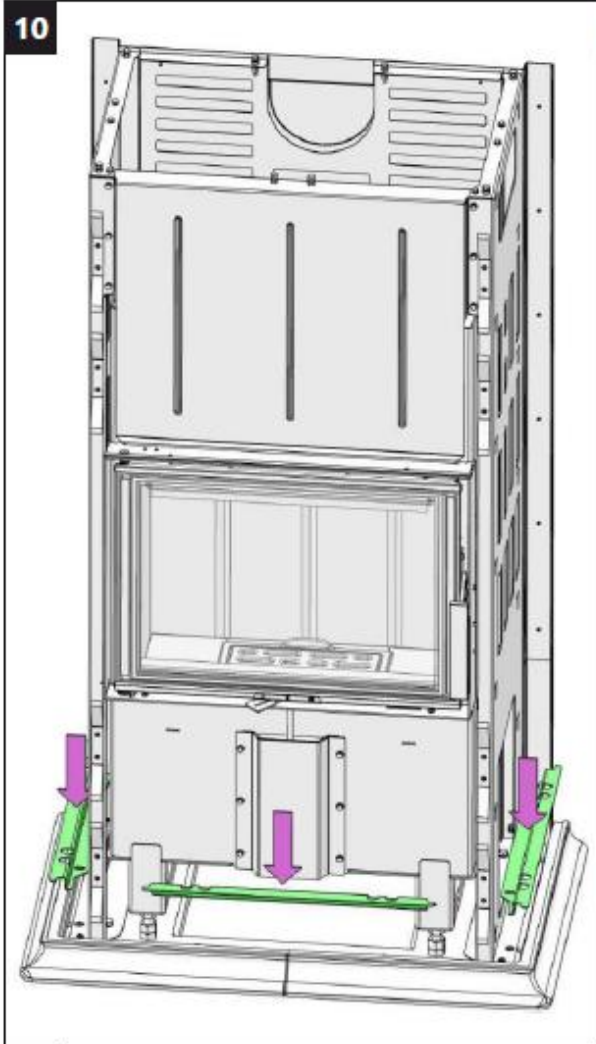

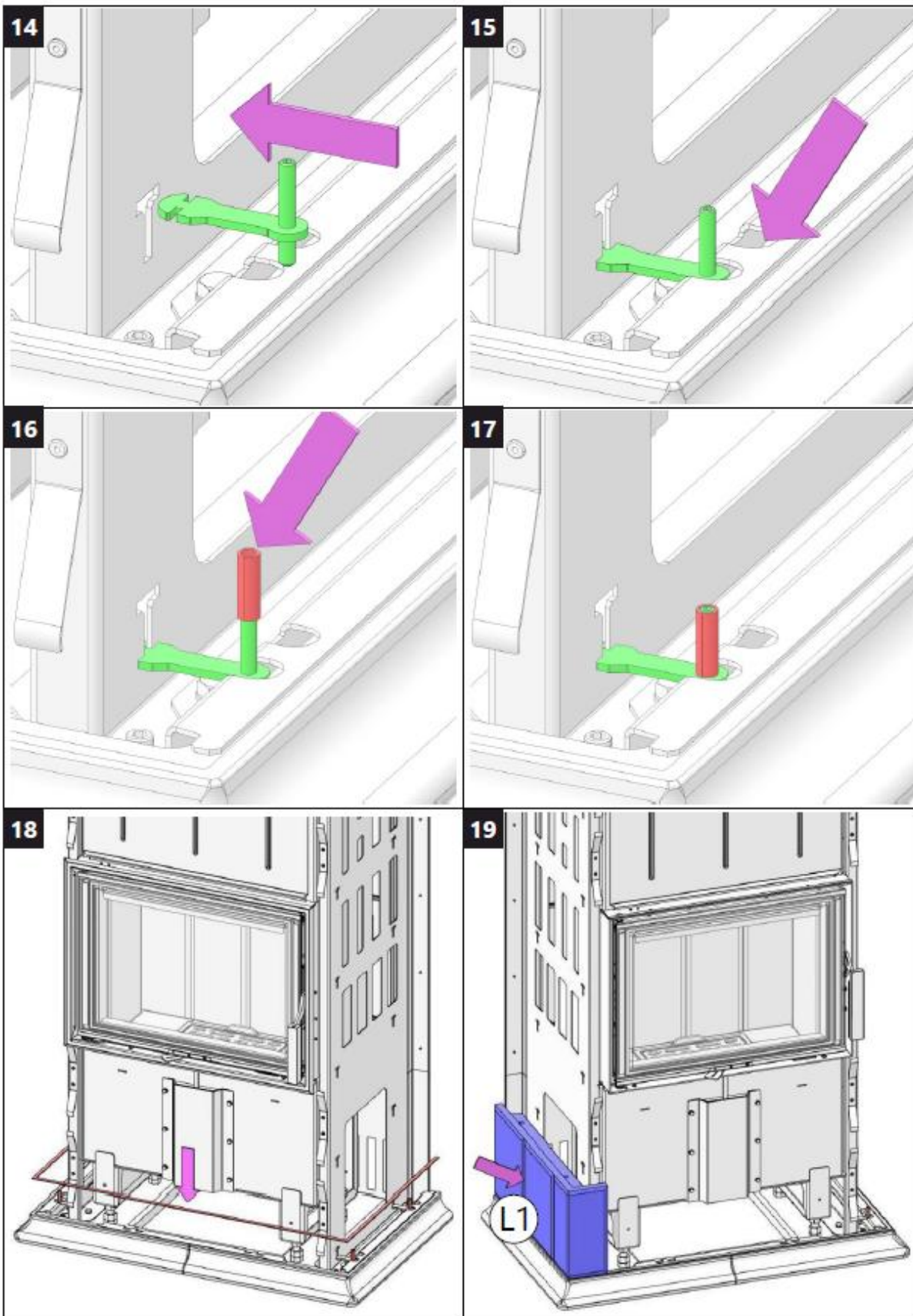

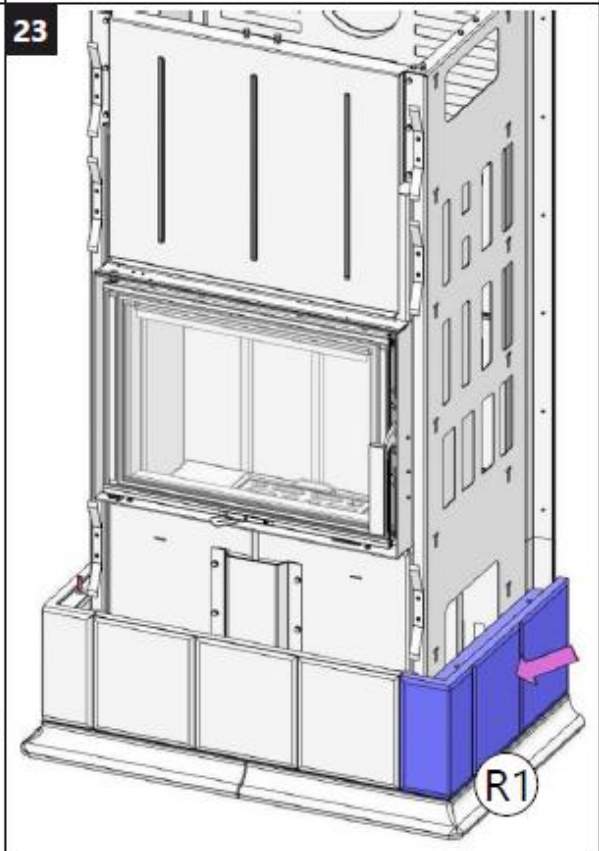
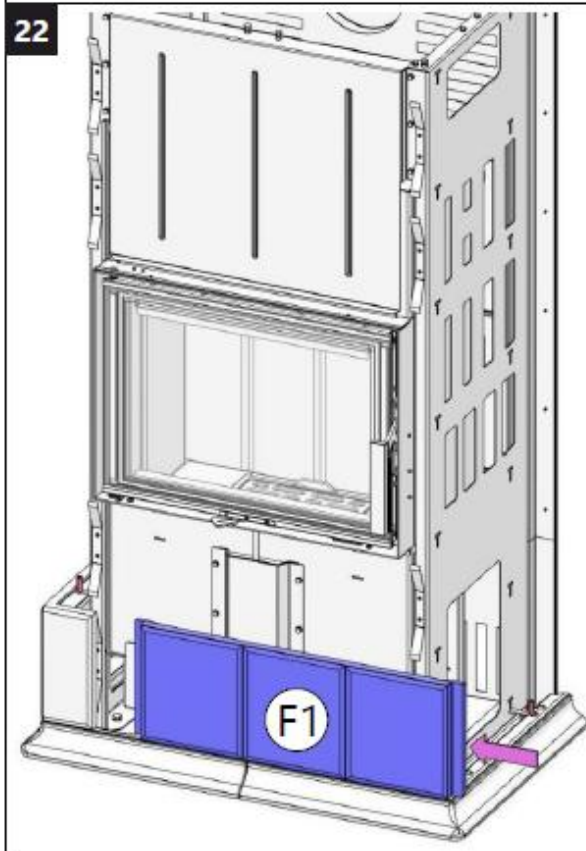
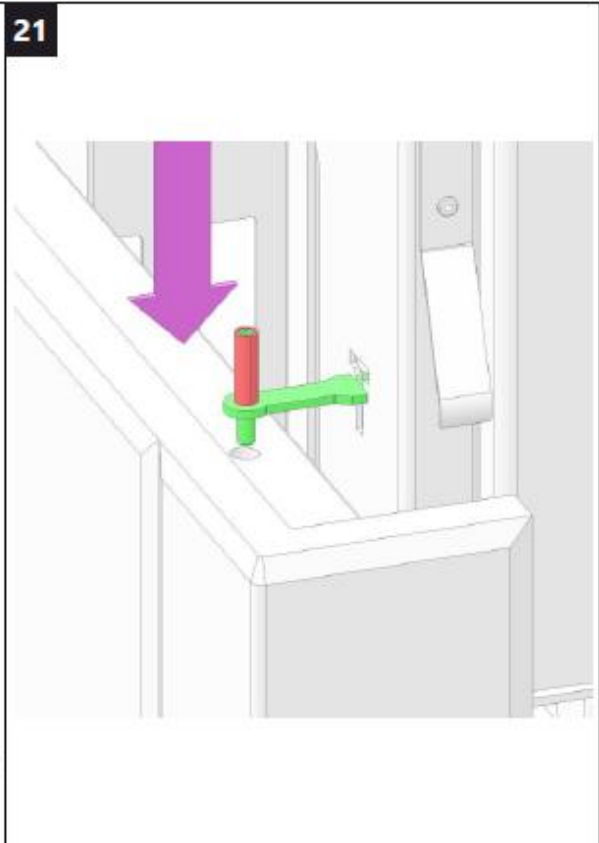
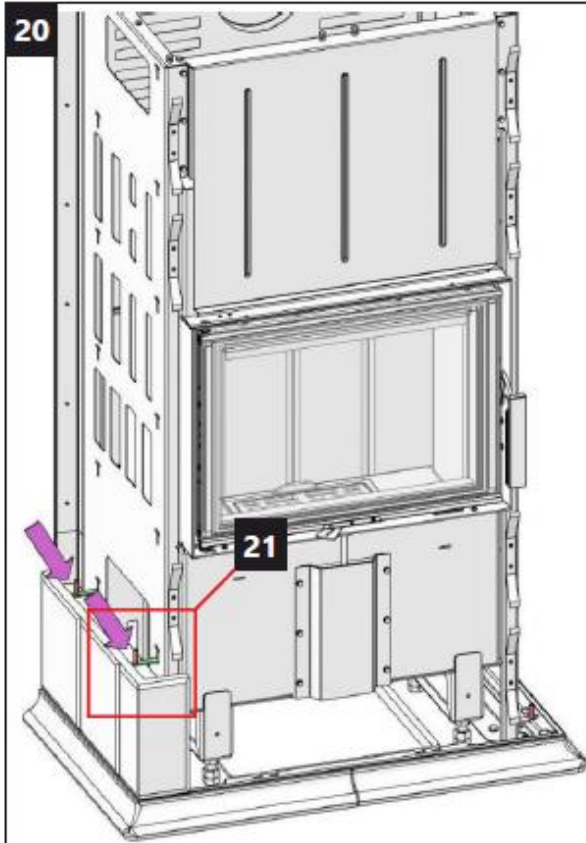

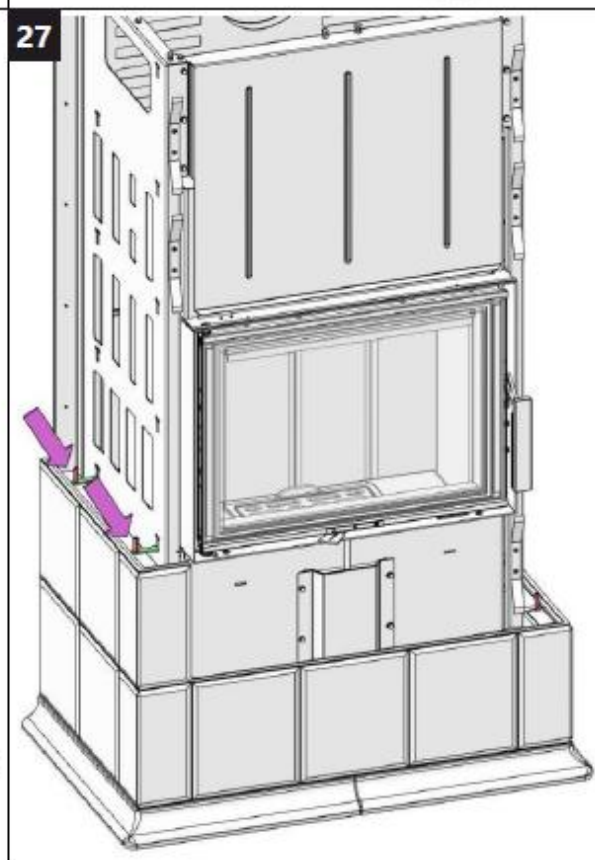
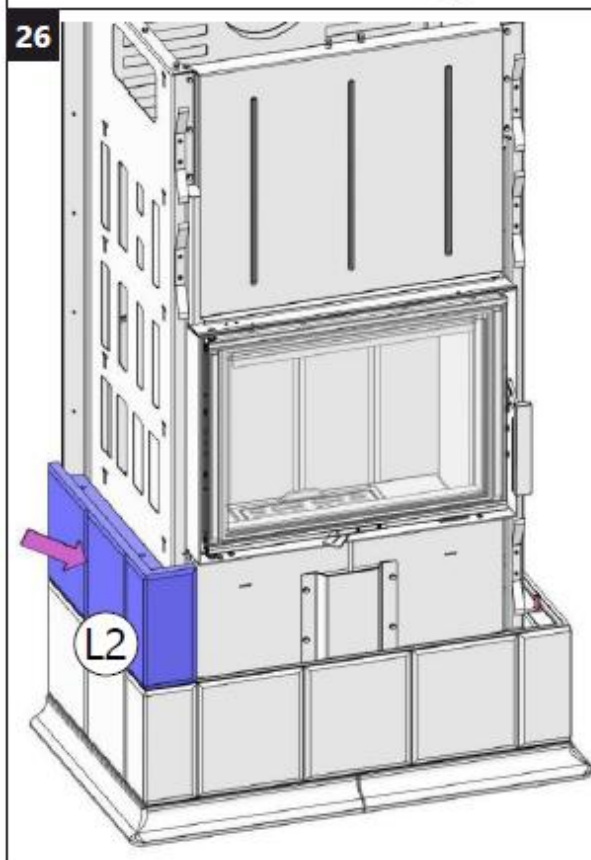
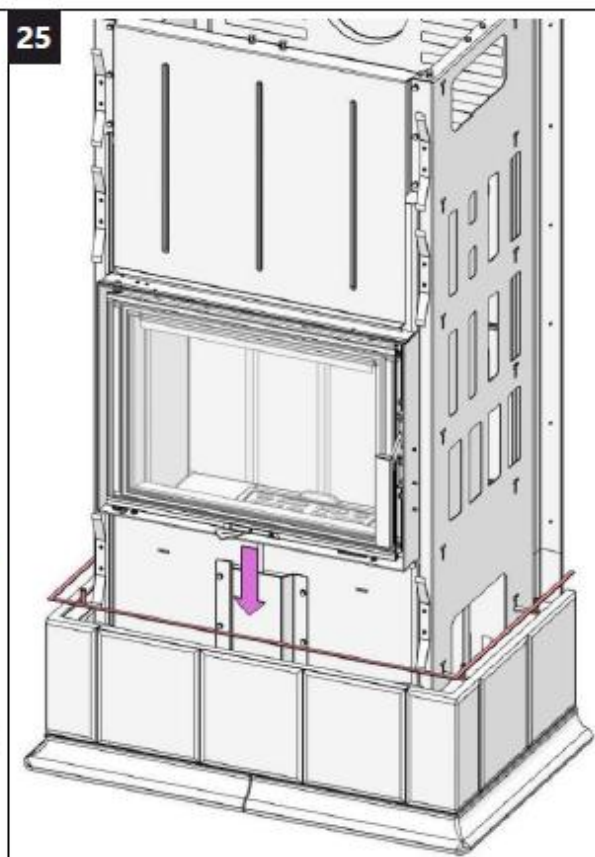
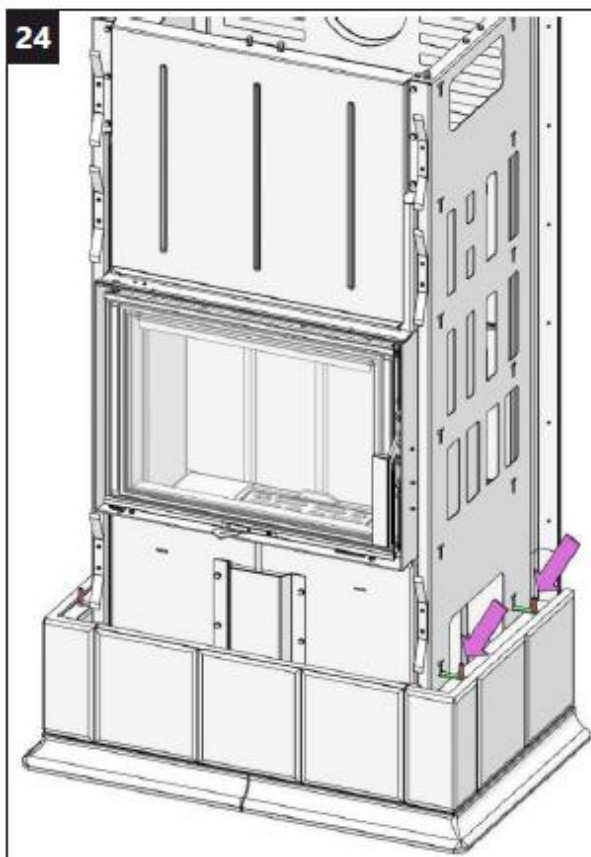

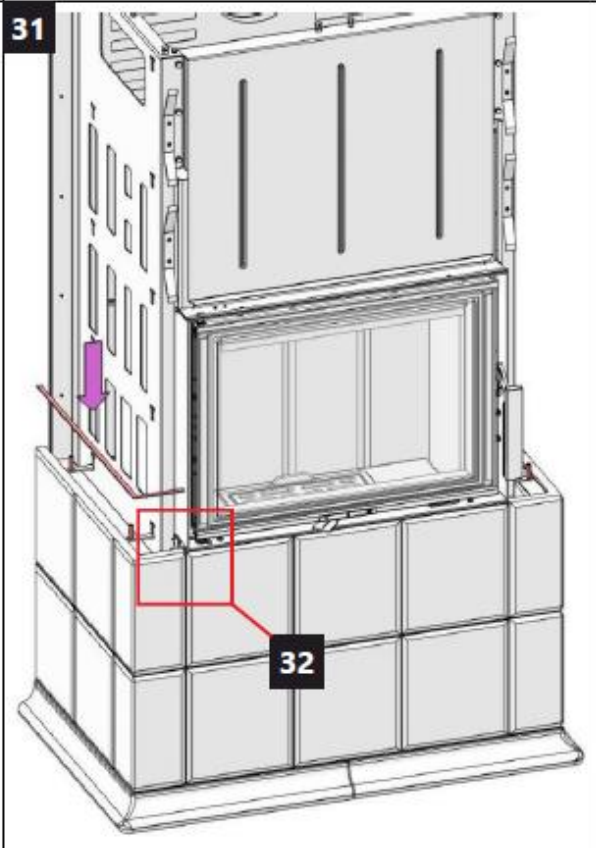
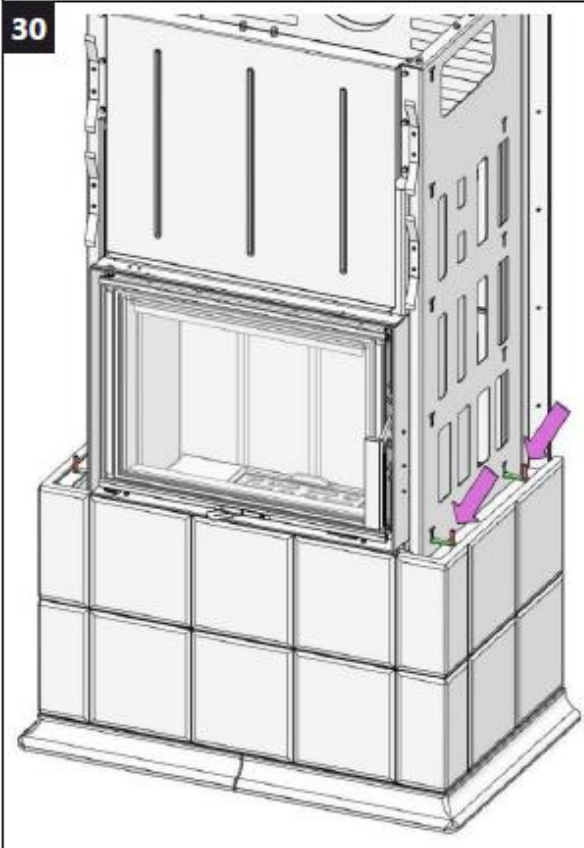
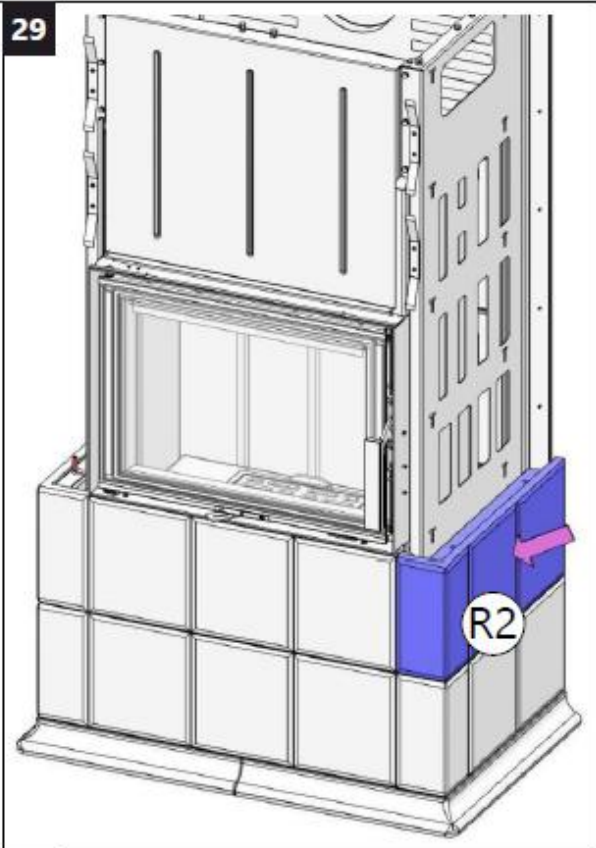
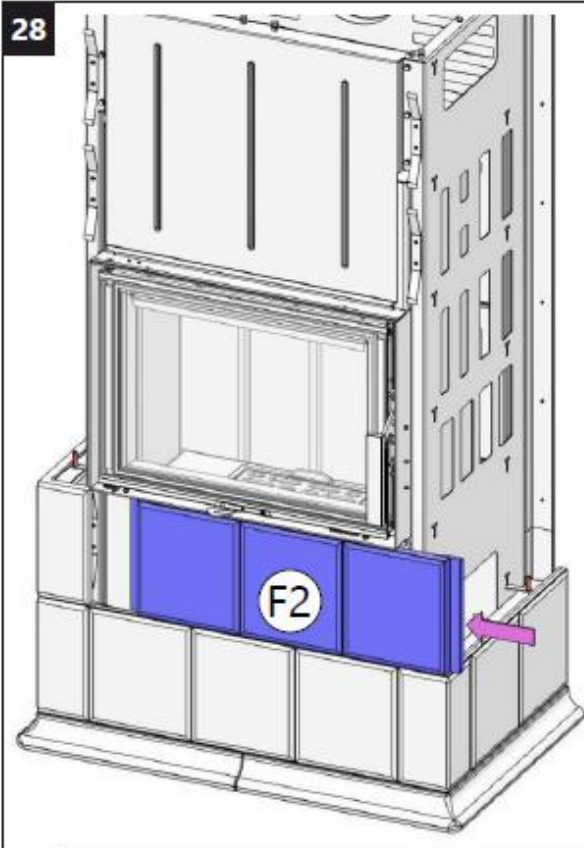

32

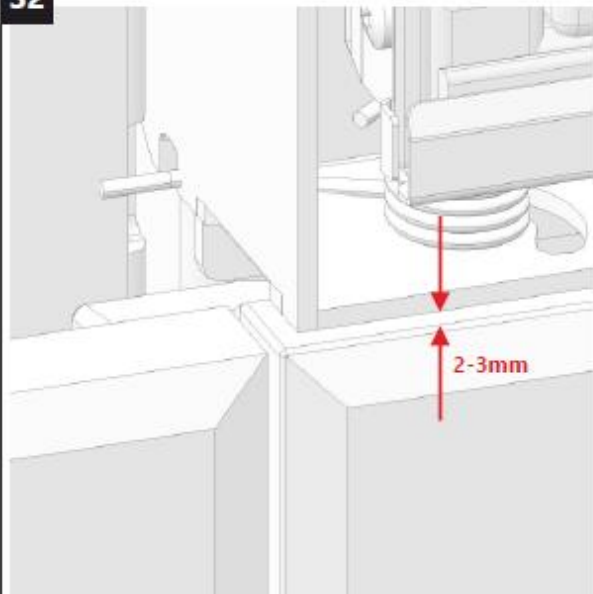

33

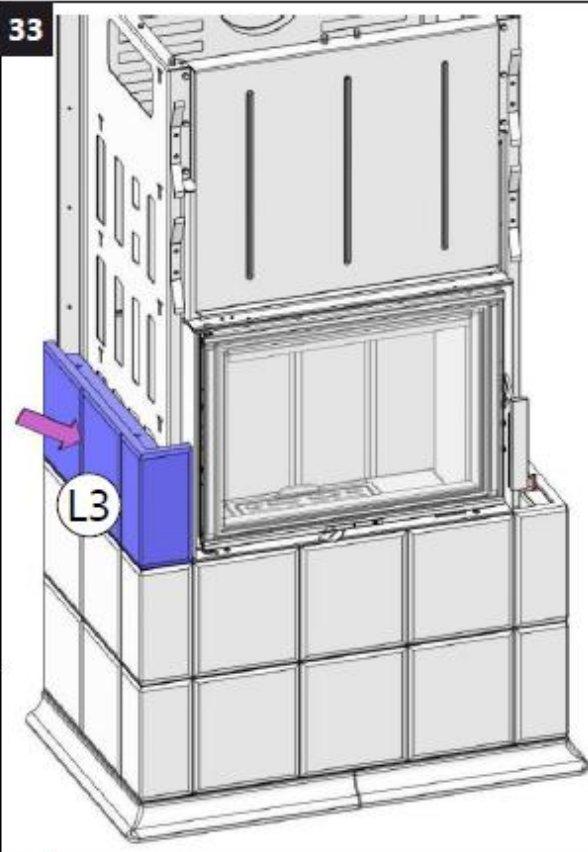

34

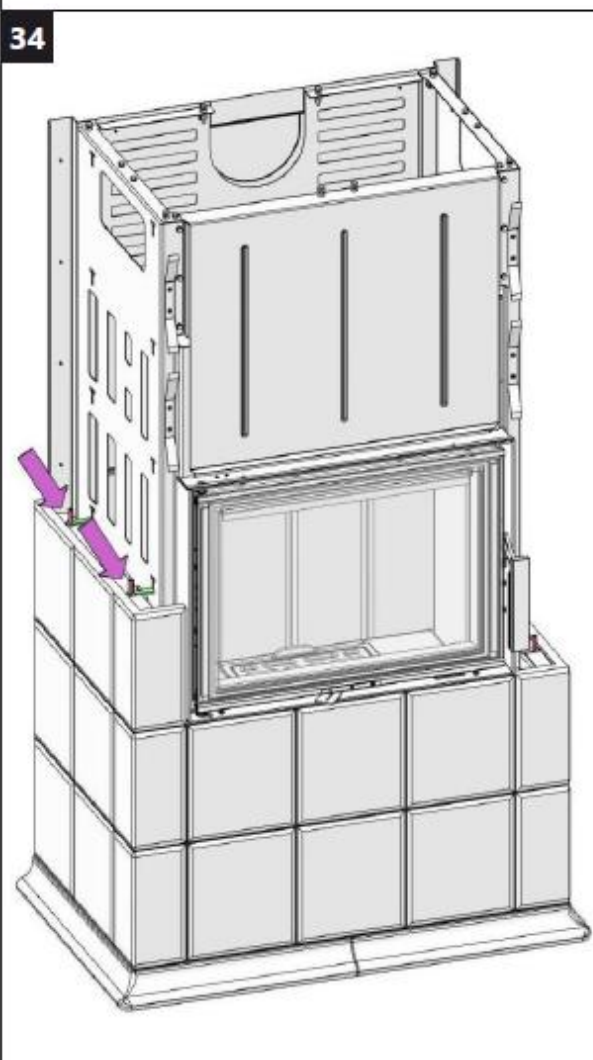

35

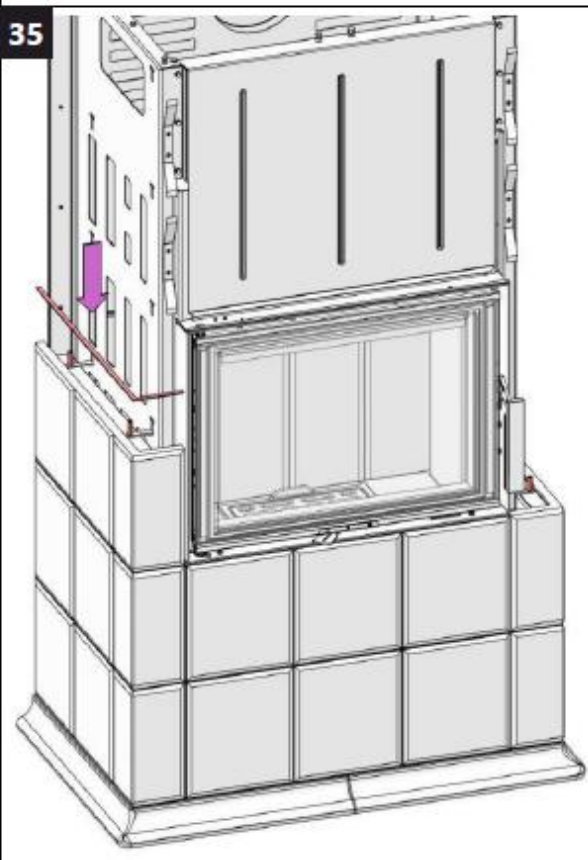

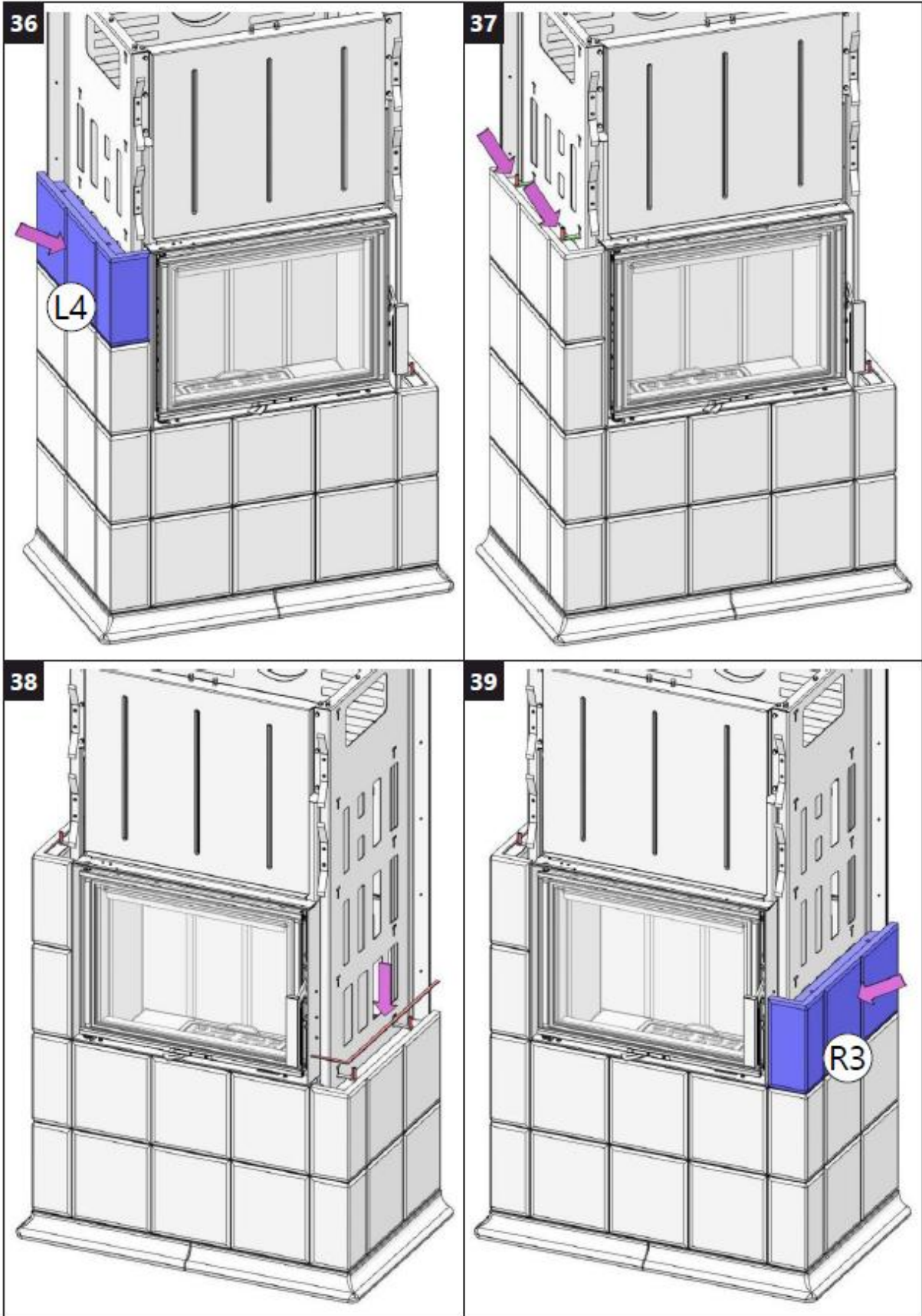

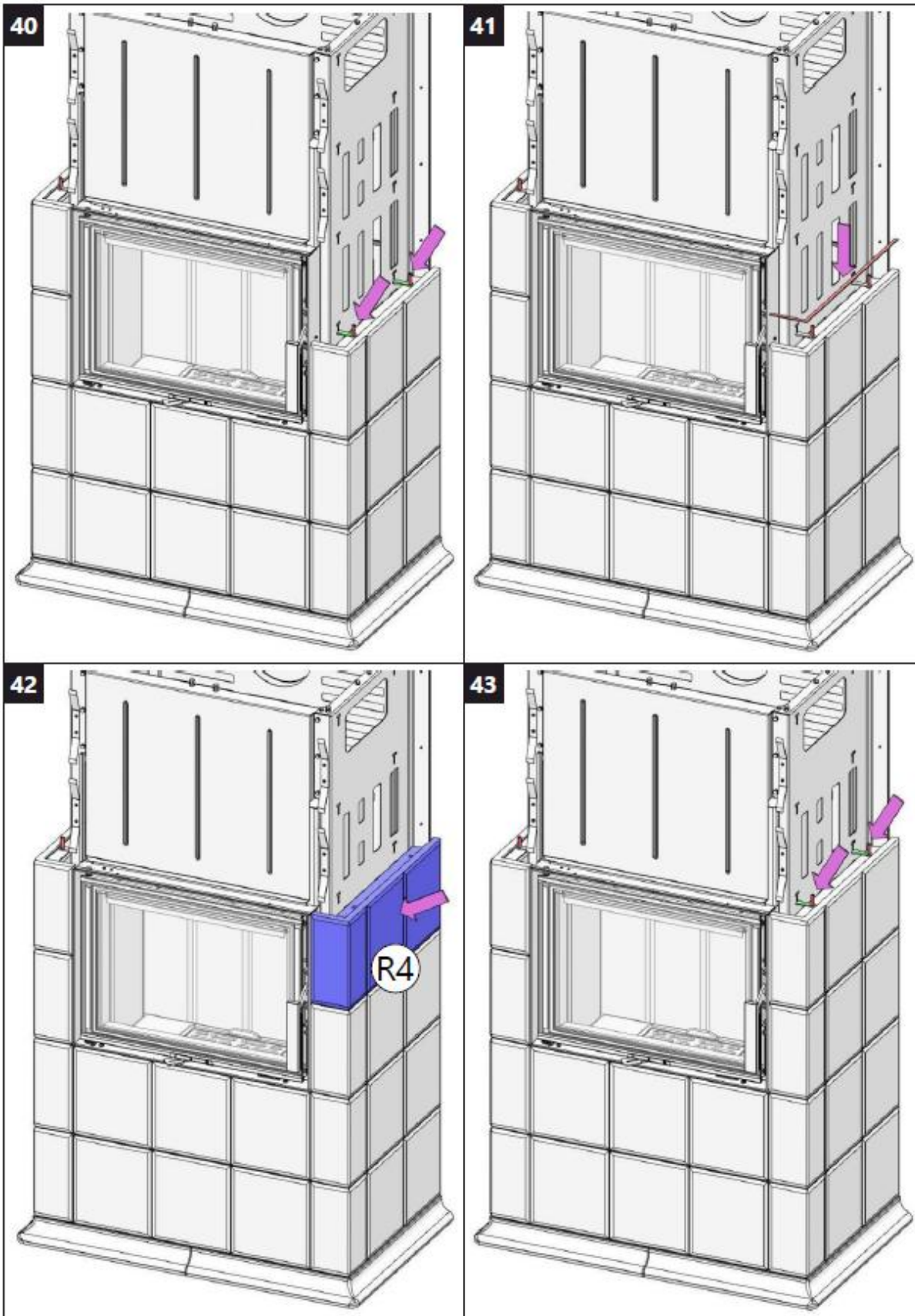

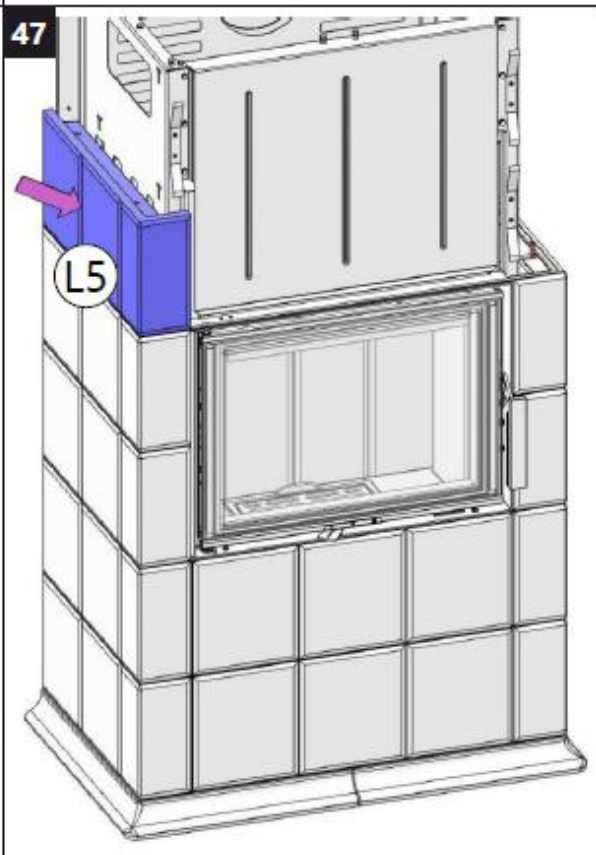
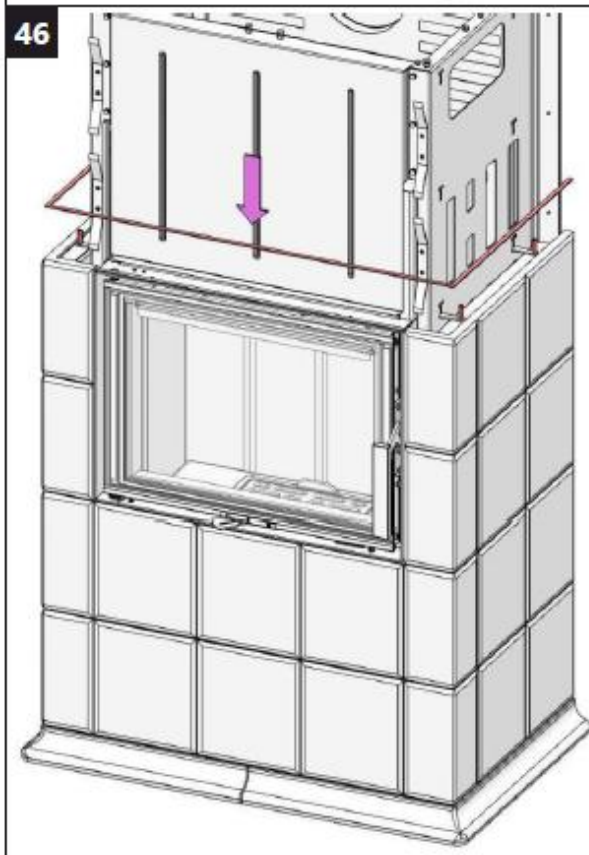
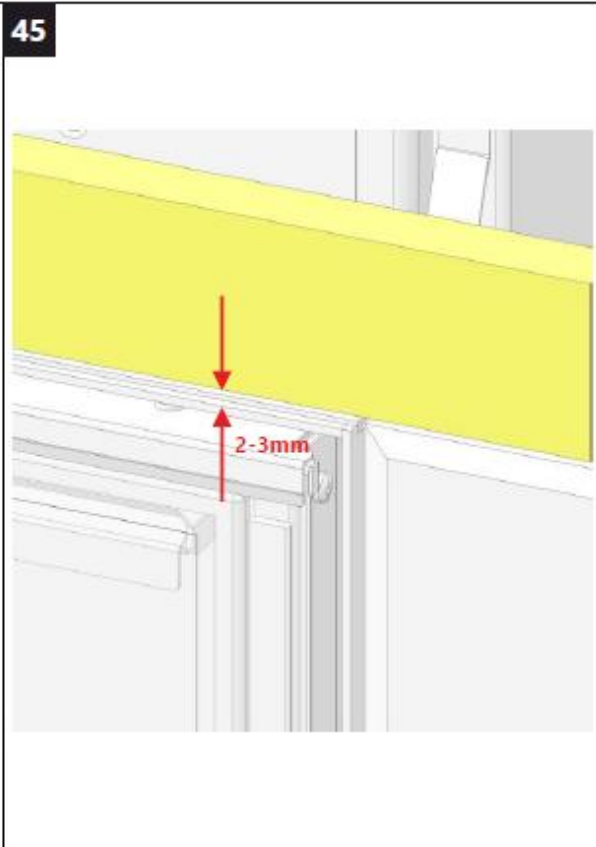
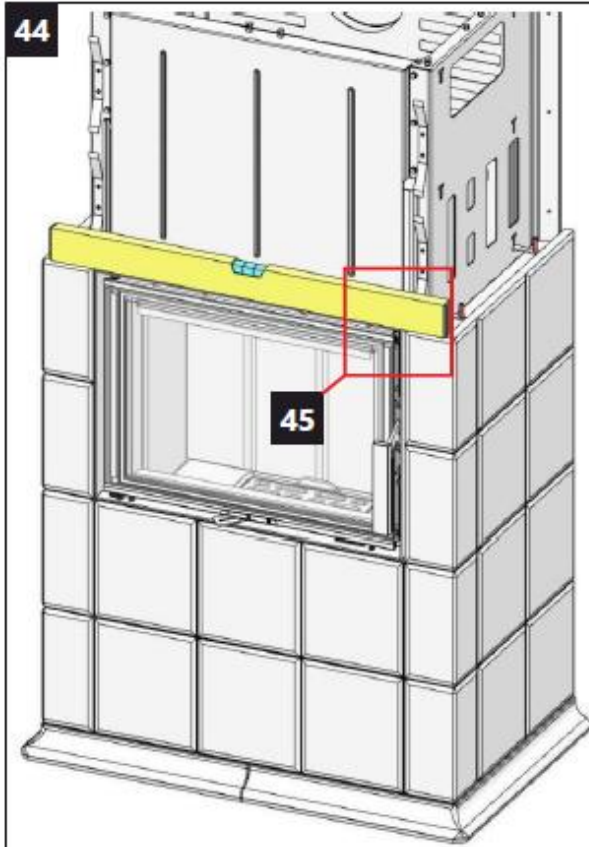

48

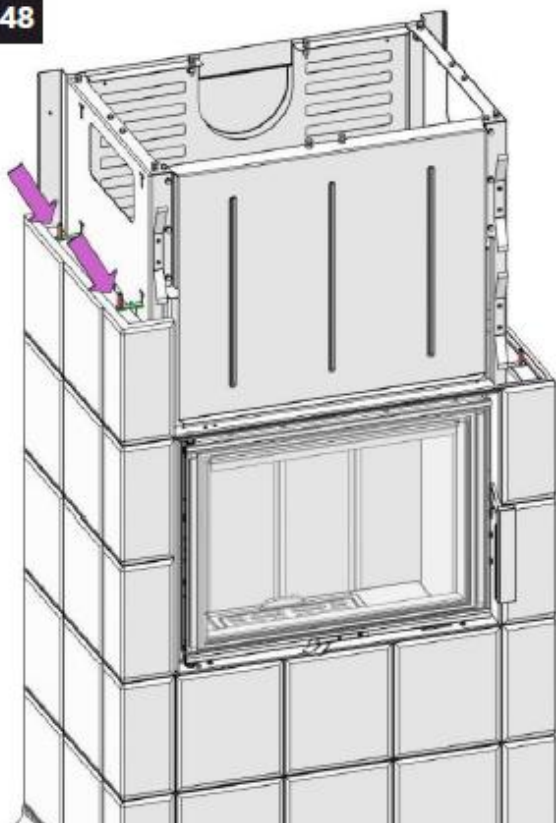

49

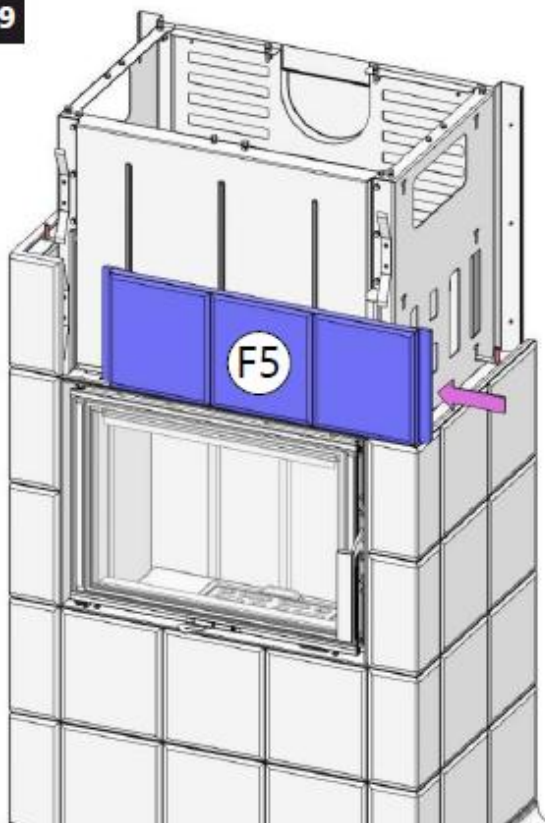

50

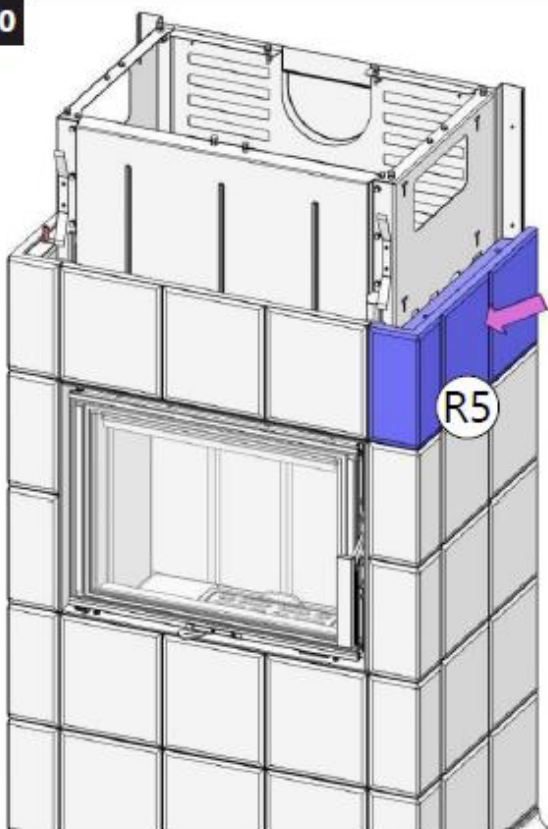

51

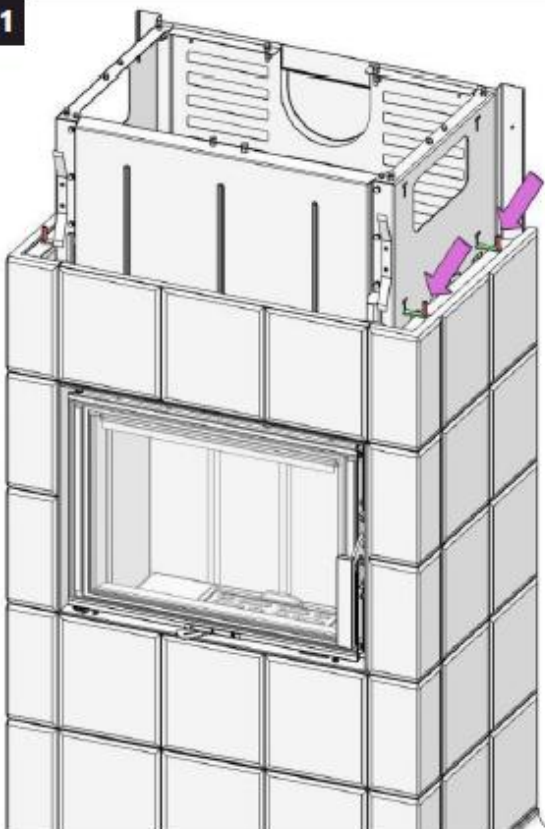

52

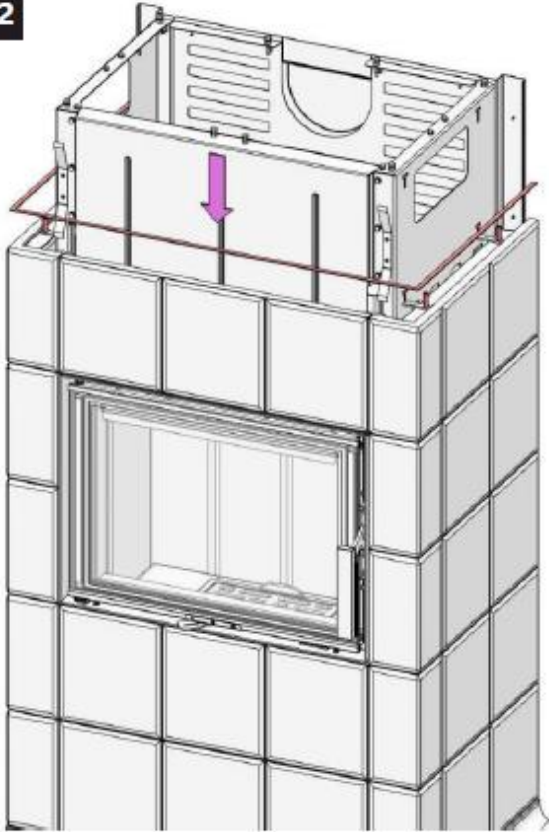

53

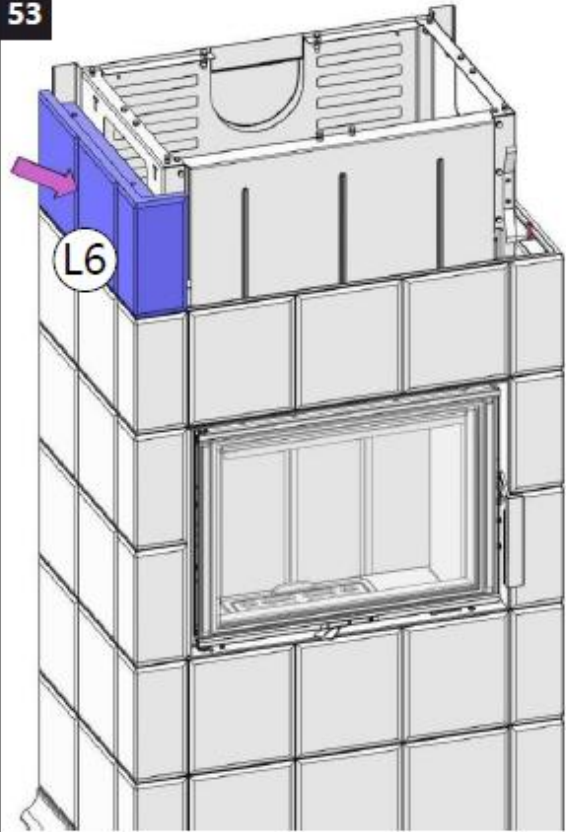

54

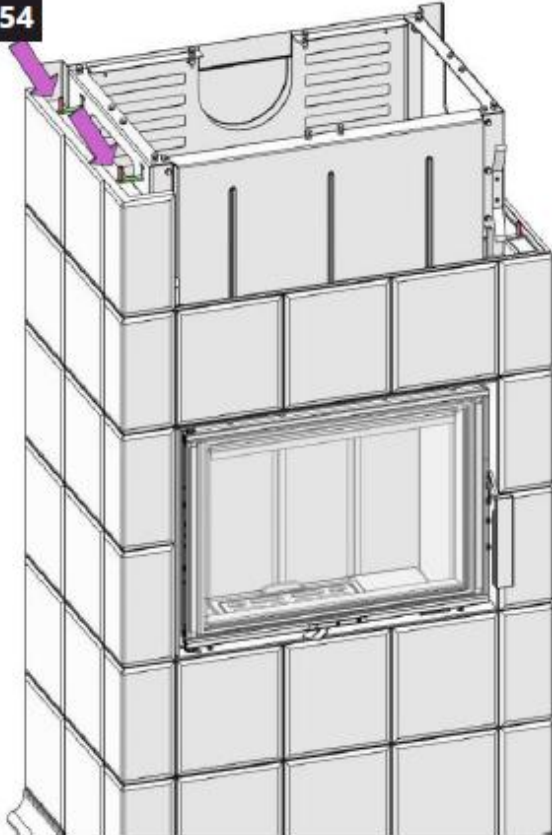

55

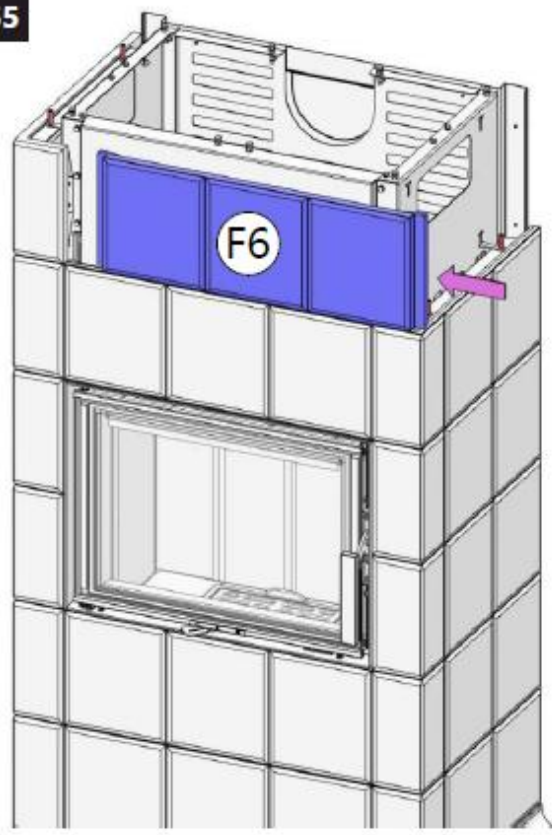

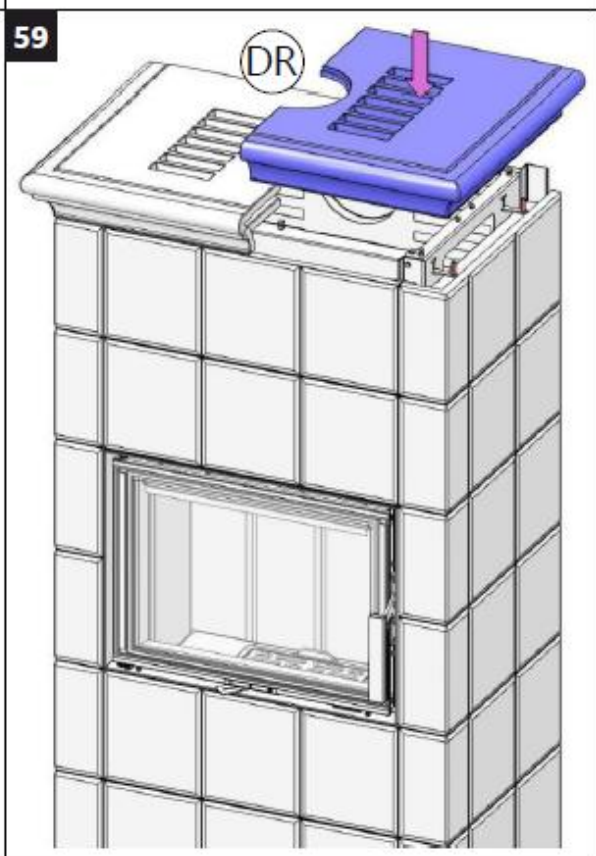
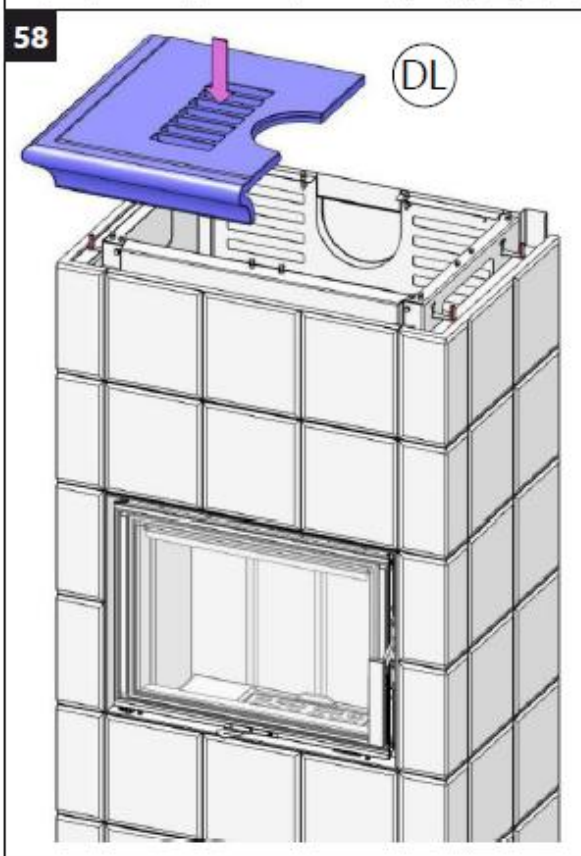
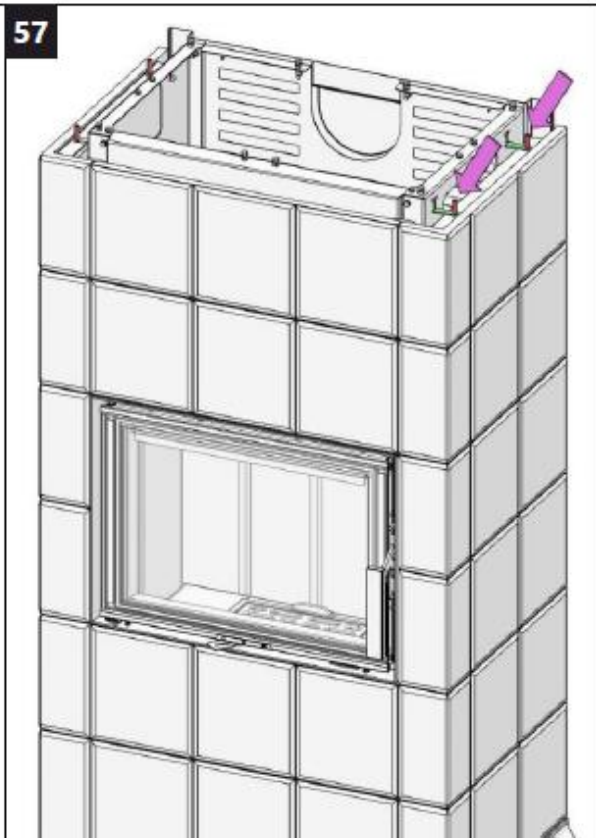
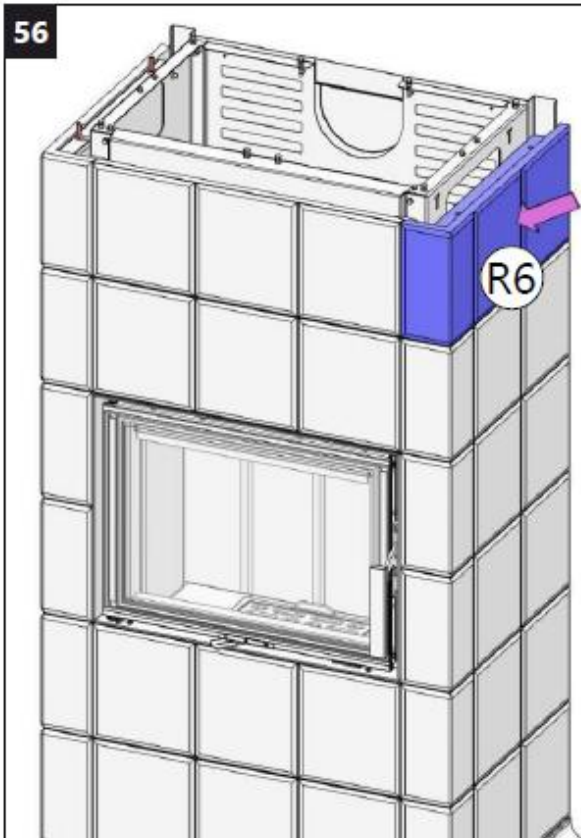

60

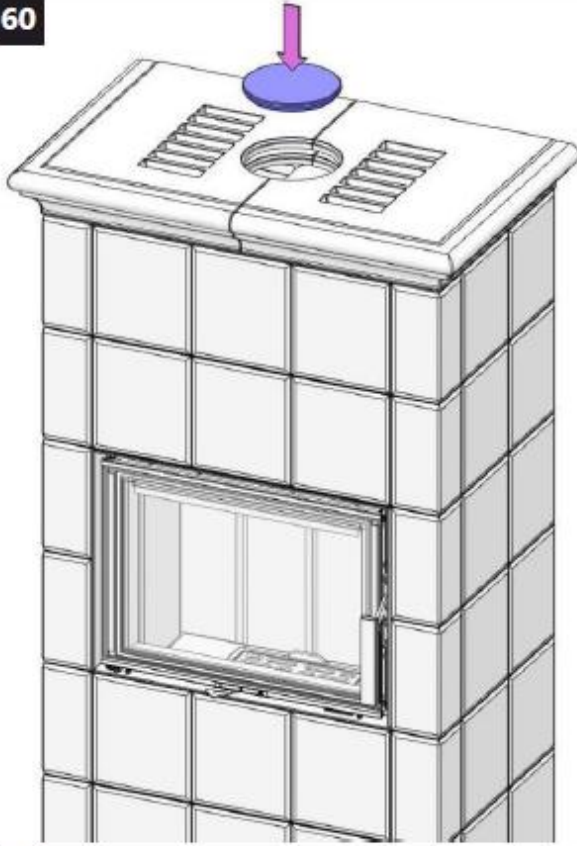

61

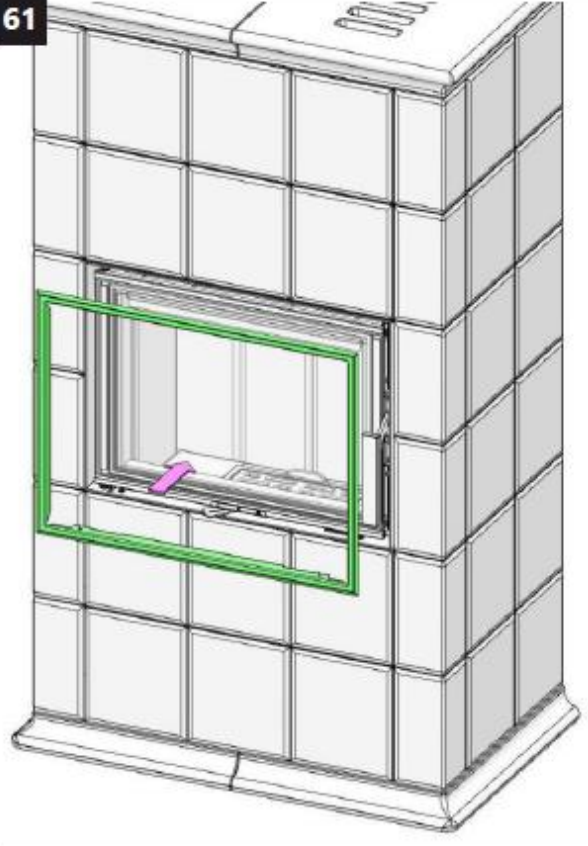

62

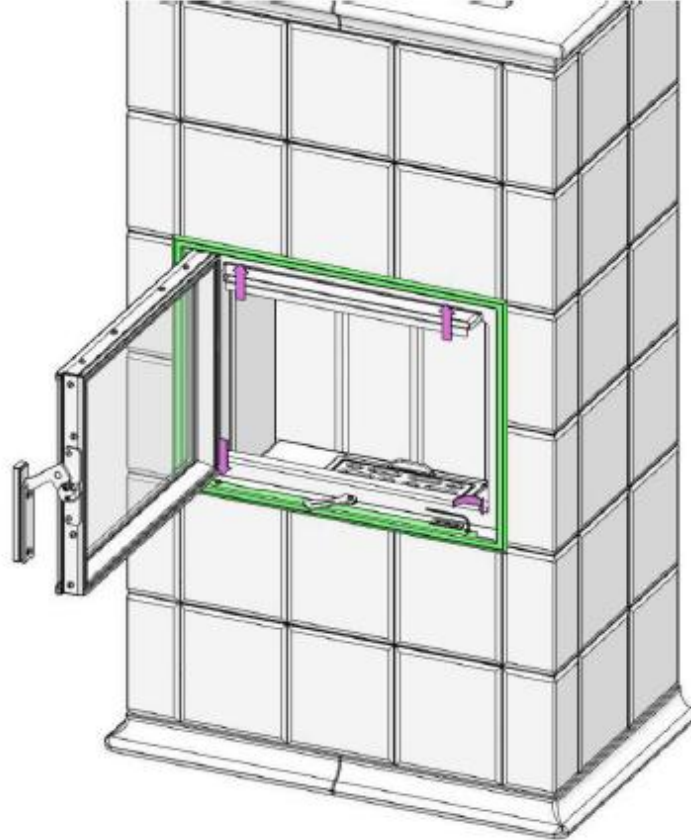

Gelieve bij problemen in onderhoud of werking uw installateur te contacteren  
Veuillez contacter votre installateur en cas de problèmes d'entretien ou de fonctionnement  
Please contact your installer in case of maintenance or operation problems

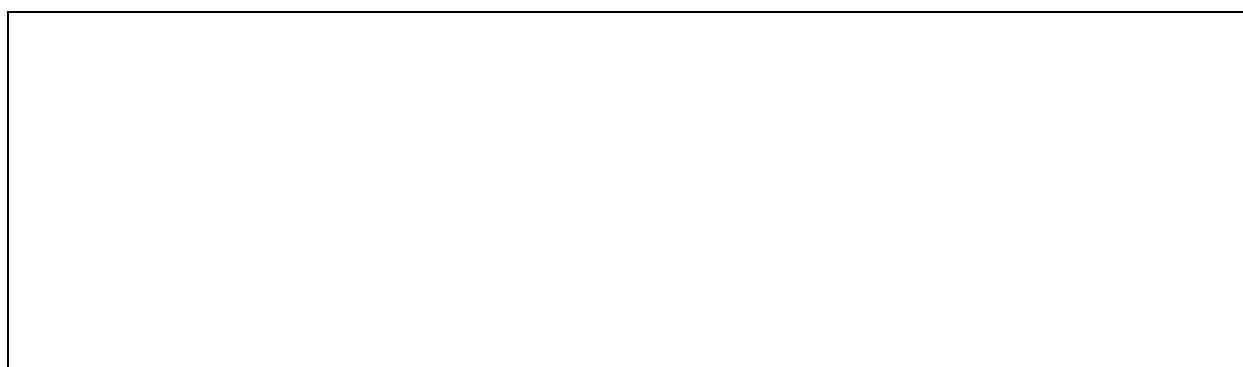

Industriepark De Bruwaan 17  
9700 Oudenaarde  
Belgium

**Versie 05 2026**